

**Electoral Division of Olds-Didsbury-Three Hills
Statement of Official Results - March 12, 2001**

POLL NUMBER	NAME OF POLL	NAMES ON LIST	BRENDA L. DYCK NDP	RICHARD MARZ PC	GAYLEEN ROELFSEMA LIB	NICHOLAS SEMMLER SC	V	S	D	R	% VOTER TURNOUT
1	Acme East	327	6	143	15	10	174	0	1	0	53.5
2	Acme West	401	5	211	33	3	252	0	0	0	62.8
3	Rosebud River	362	6	178	23	9	216	0	0	0	59.7
4	Dog Pound	377	6	181	19	6	212	0	0	1	56.5
5	Cremona Area	451	2	228	23	7	260	0	0	1	57.9
6	Cremona Town	293	10	148	25	6	189	0	0	0	64.5
7	Water Valley	418	20	206	26	5	257	0	0	0	61.5
8	Silver Creek	403	7	179	14	14	214	0	0	0	53.1
9	Hicklon Lake	471	7	212	27	5	251	0	0	2	53.7
10	Carstairs Meadow	206	3	118	21	2	144	0	0	0	69.9
11	Carstairs McAlpine	625	9	302	50	4	365	1	0	0	58.4
12	Carstairs Central	232	2	108	8	5	123	0	2	1	54.3
13	Carstairs Miltford	439	6	209	25	7	247	0	0	0	56.3
14	Lone Pine Creek	307	3	164	17	6	190	1	0	0	61.9
15	Linden District	429	1	109	12	7	129	0	0	0	30.1
16	Linden Village	476	10	199	10	3	222	0	0	0	46.6
17	Swalwell	351	6	137	15	5	163	0	0	0	46.4
18	Three Hills District	404	14	226	12	9	261	0	0	1	64.9
19	Three Hills South	519	17	278	31	6	332	0	0	1	64.2
20	Three Hills South Central	424	9	216	17	10	252	1	0	0	59.4
21	Three Hills Central	417	5	224	10	24	263	0	0	0	63.1
22	Three Hills North East	389	5	245	4	10	264	0	0	0	67.9
23	Three Hills North West	164	0	86	7	3	96	0	0	0	58.5
24	Sunnyslope	447	2	158	16	2	178	0	0	0	39.8
25	Lonepine	456	4	218	27	10	259	2	0	0	56.8
26	Westcott	471	3	212	34	20	269	0	0	0	57.1
27	Didsbury College Green	449	6	228	38	11	283	0	0	0	63.0
28	Didsbury Central	323	4	137	27	6	174	0	0	0	53.9
29	Didsbury Southridge	543	11	240	49	10	310	0	2	0	57.5
30	Didsbury Westhill	511	13	236	47	17	313	0	1	0	61.4
31	North Didsbury	362	11	144	37	7	199	0	0	0	55.0
32	North East Didsbury	269	9	103	26	5	143	0	4	0	54.6
33	Shantz	299	1	123	12	3	139	0	0	0	46.5
34	Barrie Lake	396	5	189	27	9	230	0	0	0	58.1
35	Grisdale	324	4	171	14	5	194	0	0	0	59.9
36	Torrington	473	8	219	33	11	271	0	0	0	57.3
37	Trochu District	286	8	152	15	5	180	0	0	0	62.9
38	Trochu East	281	12	125	40	7	184	0	0	2	66.2
39	Trochu West	417	14	173	47	11	245	0	0	1	59.0
40	Huxley	301	8	150	19	4	181	0	0	0	60.1
41	Wimborne	415	7	213	27	13	260	0	0	0	62.7
42	Netook	372	3	186	14	11	214	0	0	0	57.5
43	Eagle Hill	540	8	256	41	16	321	0	0	0	59.4
44	Olds South East	370	5	167	49	8	229	0	0	0	61.9
45	Olds Hedges	303	5	122	44	1	172	0	0	0	56.8
46	Olds Winter Lake	598	8	247	74	5	334	0	0	1	56.0
47	Olds Birch	271	2	111	36	3	152	0	0	0	56.1
48	Olds Chinook	587	6	233	78	9	326	0	0	3	56.0
49	Olds Maybank	278	5	112	35	4	156	0	0	0	56.1
50	Olds Centennial	234	0	98	23	5	126	0	0	0	53.8
51	Olds Center	361	4	148	23	5	180	0	0	0	49.9
52	Olds College	348	6	131	40	3	180	0	0	0	51.7
53	Olds Tower	354	3	180	31	9	223	0	0	0	63.0

**Electoral Division of Olds-Didsbury-Three Hills
Statement of Official Results - March 12, 2001**

POLL NUMBER	NAME OF POLL	NAMES ON LIST	BRENDA L. DYCK NDP	RICHARD MARZ PC	GAYLEEN ROELFSEMA LIB	NICHOLAS SEMMLER SC	V	S	D	R	% VOTER TURNOUT
54	Olds Silverthorne	240	4	113	29	7	153	0	0	0	63.8
55	Olds Shannon	442	4	178	51	11	244	0	0	0	55.2
56	Olds Imperial	185	2	80	19	2	103	0	0	0	55.7
57	Advance - Didsbury	0	3	129	22	2	156	0	0	0	
58	Advance - Olds	0	5	176	38	6	225	0	0	0	
59	Advance - Three Hills	0	7	140	8	4	159	0	0	0	
60	Mobile - Didsbury/Olds	0	7	103	12	16	138	0	0	0	
61	Mobile - Three Hills	0	5	93	11	10	119	0	0	0	
62	Special Ballot	0	2	52	6	1	61	1	0	24	
TOTAL		21,391	383	10,553	1,663	460	13,059	6	10	38	61.3

V = Valid Ballots S = Spoiled Ballots D = Declined Ballots R = Rejected Ballots

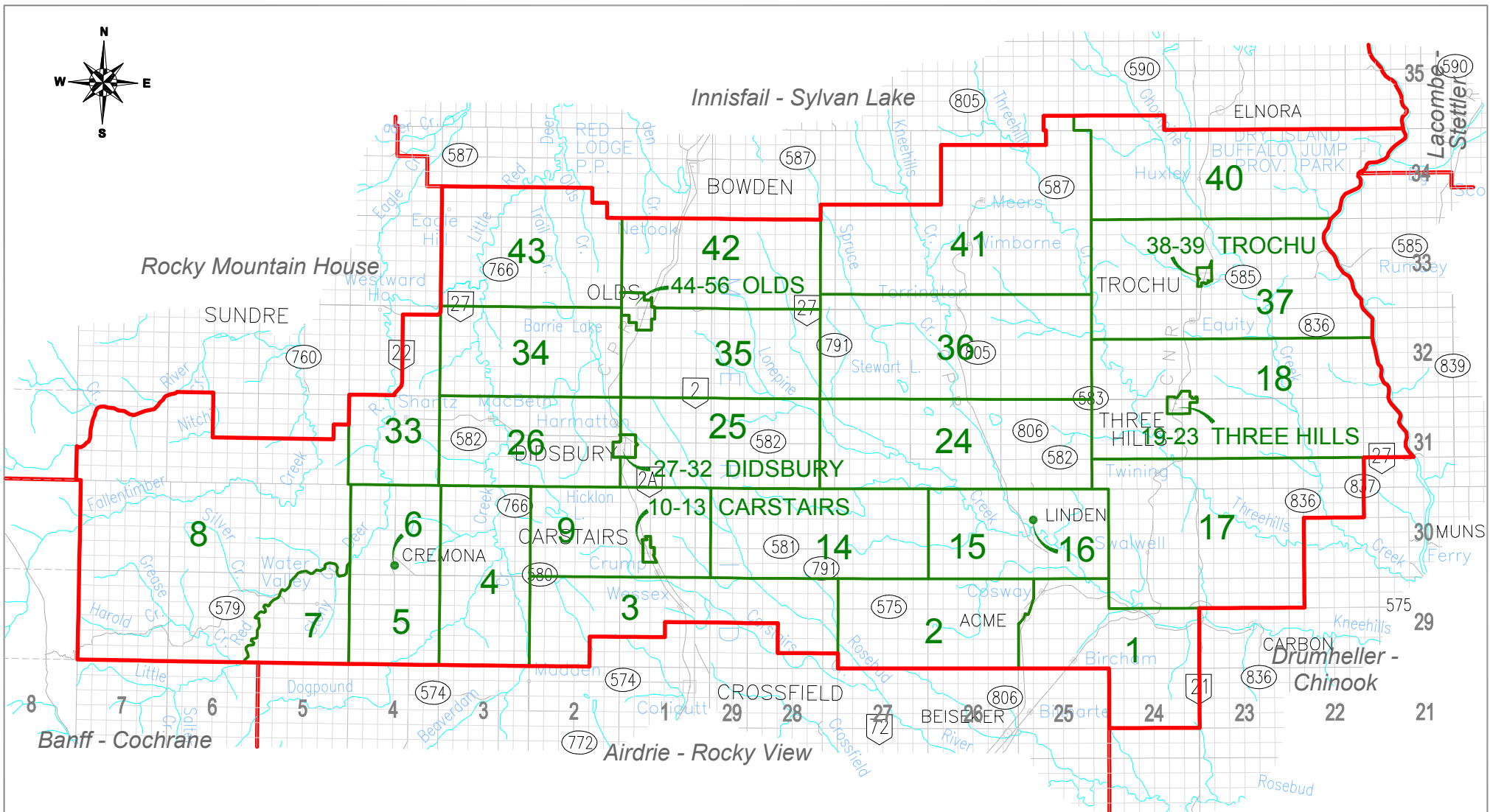

PROVINCE OF ALBERTA
PROVINCIAL ELECTORAL DIVISION
OF
66 OLDS - DIDSBURY - THREE HILLS
AS DEFINED BY THE ALBERTA ELECTORAL DIVISIONS ACT, 1996
SCALE: 0 2 4 6 8 10 12 14 16 18 20 22 kilometres
0 1 2 3 4 5 6 7 8 9 10 11 12 13 14 miles
MAP: 66A1 BASE DATA: 98/11/03 REVIEWED: 00/03/01 PSD REVISED: 99/03/01 (POLLING SUBDIVISION)

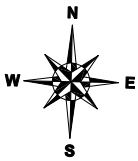

SW30 29-25-4

SE30 2

SEWER LINE R/W AND



PROVINCE OF ALBERTA

PROVINCIAL ELECTORAL DIVISION
OF

66 OLDS - DIDSBURY - THREE HILLS

AS DEFINED BY THE ALBERTA ELECTORAL DIVISIONS ACT, 1996

SCALE: 0 50 100 150 200 250 300 metres
0 200 400 600 800 1000 feet

MAP: 66B1 BASE DATA: 00/07/03 REVIEWED: 00/03/01 PSD REVISED: 99/03/01 (POLLING SUBDIVISION)

2

SECONDARY ROAD 806

MUNICIPAL BOUNDARY

DITCH

NE19 29-25-4

NW19 29-25-4

NE19 29-25-4

PARCEL G

2

CROSS STREET

WALSH AVENUE

LOT 3
LOT 2
LOT 1

THOMPSON ST

ROAD

SW19 29-25-4

WAYSIDE CAMPSITE

1

PARCEL F

SE19 29-25-4

CANADIAN PACIFIC RAILWAY

1

SW19 29-25-4

LOT 1

LOT 2

SW19

SW19

ROADWAY

MUNICIPAL BOUNDARY

VILLAGE OF ACME

1

806

TOWN OF CARSTAIRS

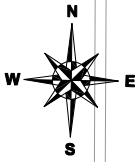

MUNICIPAL BOUNDARY

HIGHFIELD DR

CP RAIL

HIGHWAY 2A

13

GREY STREET

12

MUNICIPAL BOUNDARY

GOUGH ROAD

11

SH 580

N.E. 1/4 SEC. 8-30-1-5

MUNICIPAL BOUNDARY

10

S.E. 1/4 SEC. 8-30-1-5

HIGHWAY 2A

S.W. 1/4 SEC. 9-30-1-5

MUNICIPAL BOUNDARY



PROVINCE OF ALBERTA

PROVINCIAL ELECTORAL DIVISION
OF

66 OLDS - DIDSBURY - THREE HILLS

AS DEFINED BY THE ALBERTA ELECTORAL DIVISIONS ACT, 1996

SCALE: 0 100 200 300 400 500 600 metres
0 500 1000 1500 2000 feet

MAP: 66C1 BASE DATA: 00/07/03 REVIEWED: 00/09/15 PSD REVISED: 00/09/29 (POLING SUBMISSION)

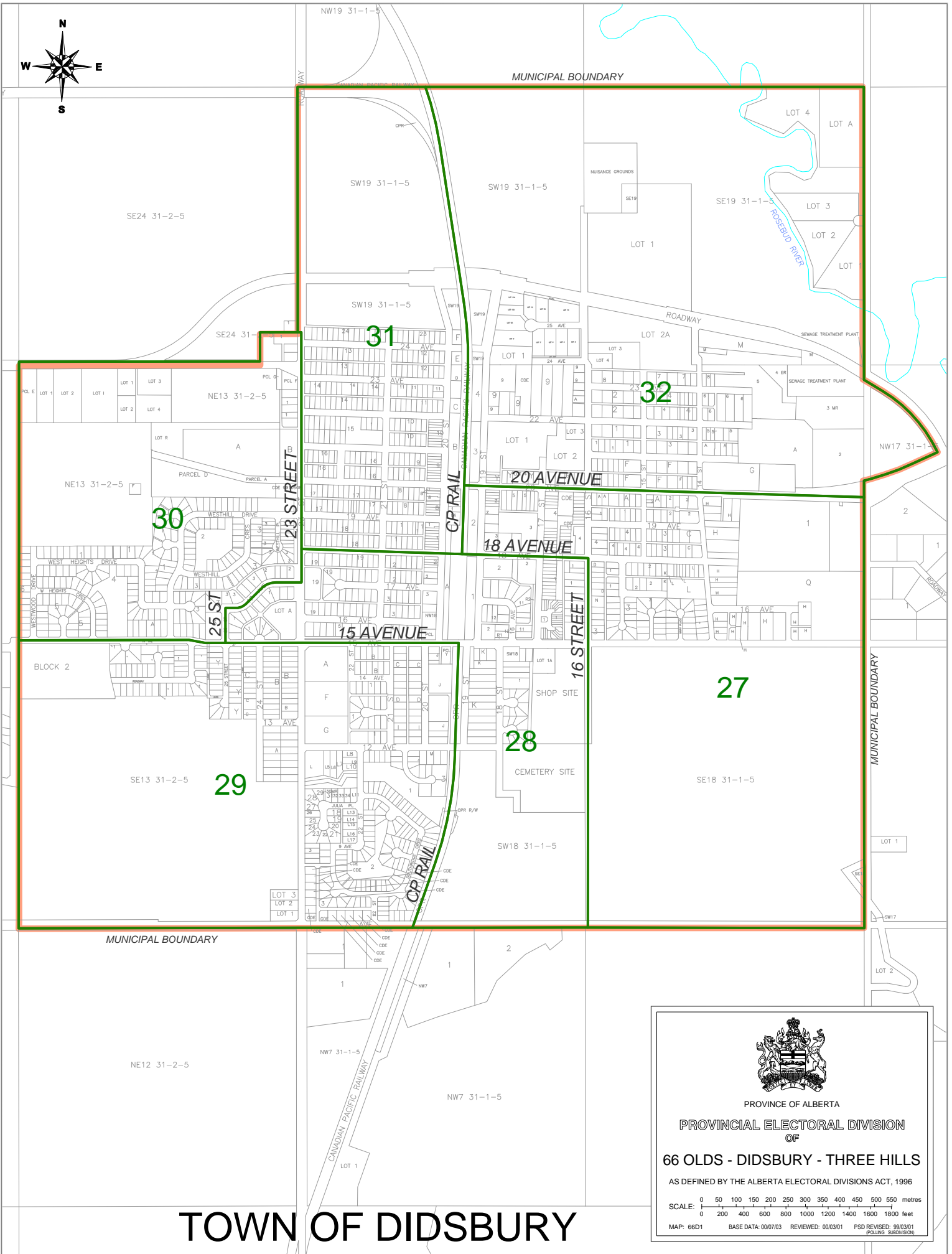
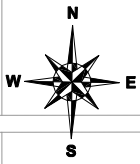

TOWN OF DIDSBURY



PROVINCE OF ALBERTA

PROVINCIAL ELECTORAL DIVISION
OF

66 OLDS - DIDSBURY - THREE HILLS

AS DEFINED BY THE ALBERTA ELECTORAL DIVISIONS ACT, 1996

SCALE: 0 50 100 150 200 250 300 350 400 450 500 550 metres
0 200 400 600 800 1000 1200 1400 1600 1800 feet

MAP: 66D1 BASE DATA: 00/07/03 REVIEWED: 00/03/01 PSD REVISED: 99/03/01 (POLLING SUBDIVISION)

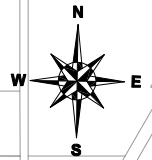

MUNICIPAL BOUNDARY

N.W. 1/4 SEC. 6-33-1-5

N.E. 1/4 SEC. 6-33-1-5

S.W. 1/4 SEC. 6-33-1-5

HIGHWAY 27

N.W. 1/4 SEC. 31-32-1-5

N.W. 1/4 SEC. 29-32-1-5

N.E. 1/4 SEC. 29-32-1-5

MUNICIPAL BOUNDARY

MUNICIPAL BOUNDARY

MUNICIPAL BOUNDARY

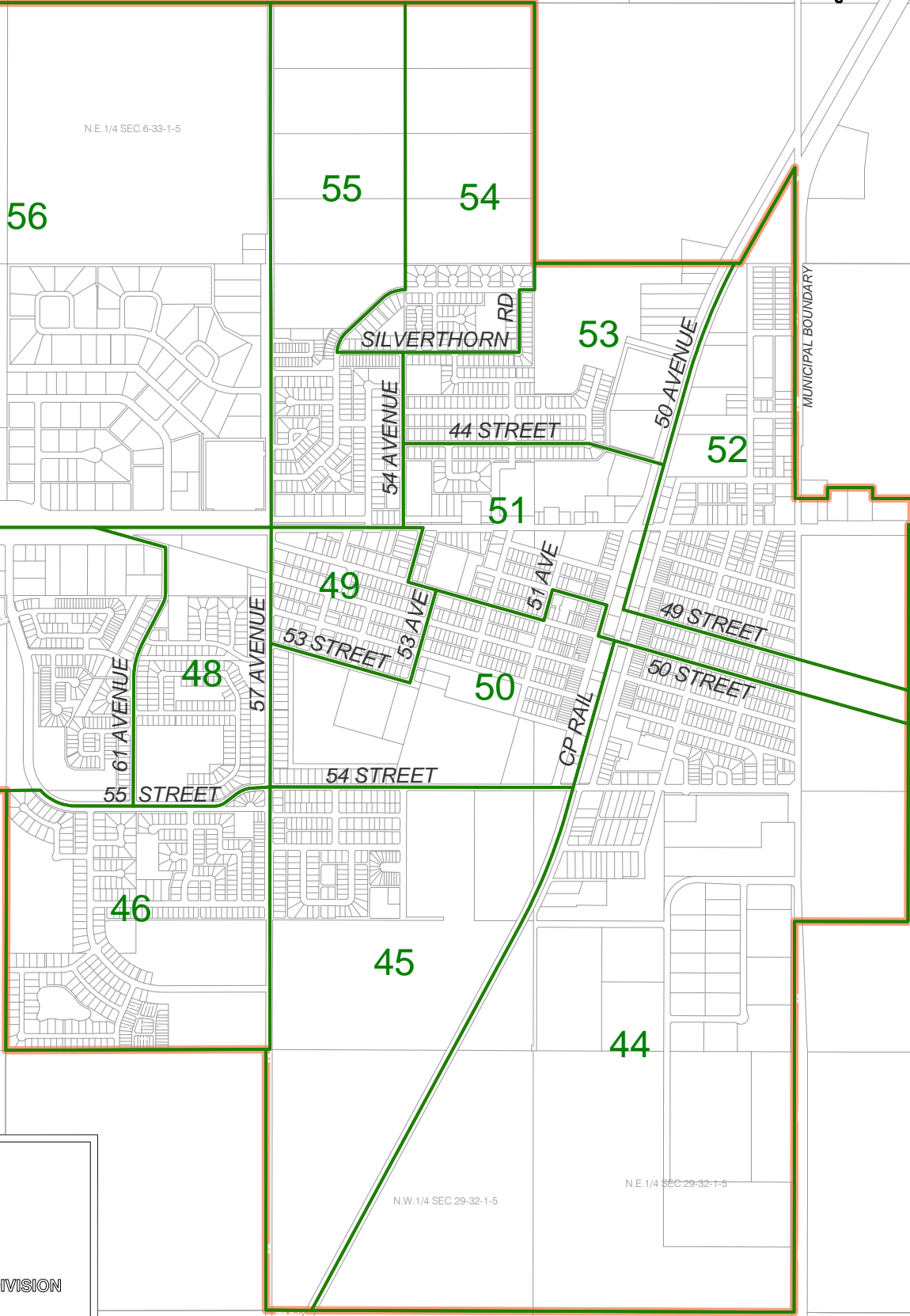

PROVINCE OF ALBERTA

PROVINCIAL ELECTORAL DIVISION
OF

66 OLDS - DIDSBURY - THREE HILLS

AS DEFINED BY THE ALBERTA ELECTORAL DIVISIONS ACT, 1996

SCALE: 0 100 200 300 400 500 600 700 metres
0 400 800 1200 1600 2000 2400 feet

MAP: 66E1 BASE DATA: 00/07/03 REVIEWED: 00/03/01 PSD REVISED: 99/03/01 (POLING SUBMISSIONS)

TOWN OF OLDS

TOWN OF THREE HILLS

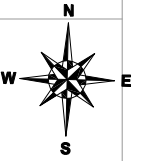

23

S.E. 1/4 SEC. 1-32-24-4

22

6 AVENUE NORTH

2 STREET NORTH

1 STREET NORTH

21

MAIN STREET

CN RAIL

20

4 AVENUE SOUTH

5 AVENUE NORTH

3 STREET SOUTH

4 STREET SOUTH

19

N.W. 1/4 SEC. 36-31-24-4

N.W. 1/4 SEC. 31-31-23-4

S.W. 1/4 SEC. 36-31-24-4

S.W. 1/4 SEC. 31-31-23-4

MUNICIPAL BOUNDARY

MUNICIPAL BOUNDARY



PROVINCE OF ALBERTA

PROVINCIAL ELECTORAL DIVISION
OF

66 OLDS - DIDSBURY - THREE HILLS

AS DEFINED BY THE ALBERTA ELECTORAL DIVISIONS ACT, 1996

SCALE: 0 50 100 150 200 250 300 350 400 450 500 metres
0 200 400 600 800 1000 1200 1400 1600 feet

MAP: 66F1 BASE DATA: 00/07/03 REVIEWED: 00/03/01 PSD REVISED: 99/03/01
(POLLING SUBDIVISION)



PROVINCE OF ALBERTA

PROVINCIAL ELECTORAL DIVISION
OF

66 OLDS - DIDSBURY - THREE HILLS

AS DEFINED BY THE ALBERTA ELECTORAL DIVISIONS ACT, 1996

SCALE: 0 50 100 150 200 250 300 350 400 metres
0 200 400 600 800 1000 1200 1400 feet

MAP: 66G1 BASE DATA: 00/07/03 REVIEWED: 00/03/01 PSD REVISED: 99/03/01 (POLLING SUBDIVISION)

TOWN OF TROCHU

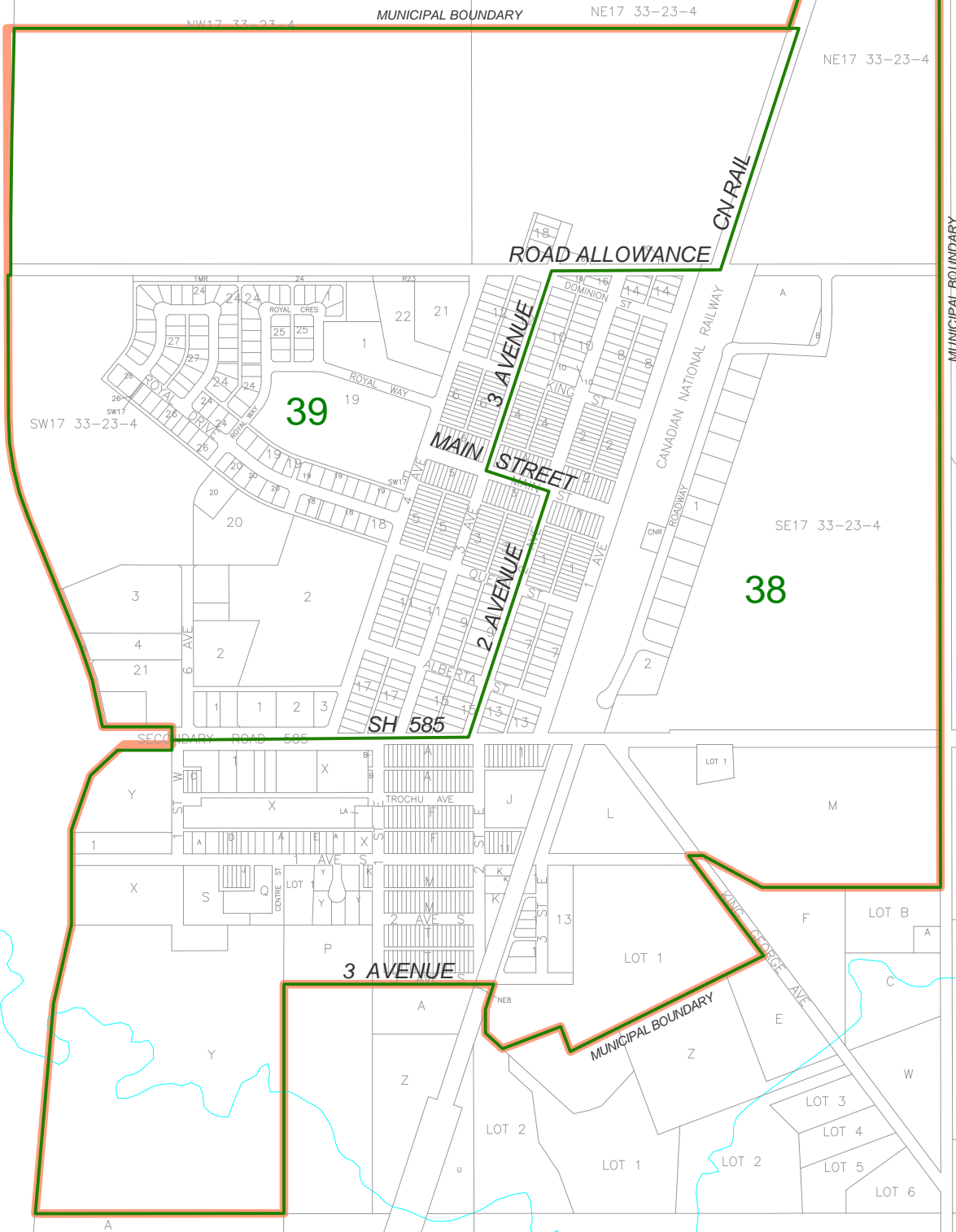
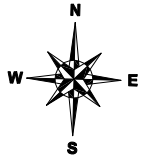

**Electoral Division of Peace River
Statement of Official Results - March 12, 2001**

POLL NUMBER	NAME OF POLL	NAMES ON LIST	SUSAN CALLIHOO LIB	STEVE CROCKER NDP	GARY FRIEDEL PC	JOHN IFTODY AFP	V	S	D	R	% VOTER TURNOUT
53	Mobile - Peace River	0	3	7	35	2	47	0	0	0	
54	Mobile - Manning	0	5	2	26	3	36	0	0	0	
55	Special Ballot	0	18	2	43	1	64	0	0	6	
TOTAL		16,176	1,544	338	3,782	206	5,870	9	1	12	36.4

V = Valid Ballots S = Spoiled Ballots D = Declined Ballots R = Rejected Ballots

**Electoral Division of Peace River
Statement of Official Results - March 12, 2001**

POLL NUMBER	NAME OF POLL	NAMES ON LIST	SUSAN CALLIHOO LIB	STEVE CROCKER NDP	GARY FRIEDEL PC	JOHN IFTODY AFP	V	S	D	R	% VOTER TURNOUT
1	Zama Lake	60	1	0	10	0	11	0	0	0	18.3
2	Meander River	93	18	6	7	0	31	0	0	0	33.3
3	Assumption	478	46	3	15	0	64	1	0	0	13.4
4	Rainbow North	364	26	2	105	3	136	0	0	0	37.4
5	Rainbow South	98	5	0	32	0	37	0	0	0	37.8
6	High Level McLarty	358	26	1	80	1	108	0	0	0	30.2
7	Bobby Gray	340	33	6	84	1	124	0	0	0	36.5
8	High Level Centre	333	39	4	74	4	121	0	0	0	36.3
9	High Level Walters	377	33	2	37	0	72	0	0	0	19.1
10	High Level	257	16	4	32	2	54	0	0	0	21.0
11	High Level Rural	488	32	6	128	2	168	0	0	1	34.6
12	Rocky Lane	423	21	2	56	0	79	1	0	0	18.7
13	Boyer River	150	20	2	21	2	45	0	0	0	30.0
14	Fort Vermilion Rural	181	9	1	38	0	48	0	0	0	26.5
15	Fort Vermilion	433	36	3	66	5	110	0	0	0	25.4
16	Blumenort	363	4	0	39	4	47	1	0	0	12.9
17	La Crete Rural	440	15	1	59	4	79	0	0	0	18.0
18	La Crete North	563	15	0	95	3	113	0	0	0	20.1
19	La Crete South	346	25	2	106	2	135	0	0	0	39.0
20	Wilson Prairie	404	5	0	54	6	65	0	0	0	16.1
21	Buffalo Head Praire	530	3	0	41	4	48	0	0	0	9.1
22	Paddle Prairie	371	25	6	17	2	50	0	0	0	13.5
23	Keg River	102	6	2	25	3	36	0	0	0	35.3
24	Hotchkiss	224	19	10	54	26	109	0	0	0	48.7
25	Manning East	216	20	4	48	8	80	0	0	0	37.0
26	Manning Town North	352	17	6	100	4	127	1	0	2	36.6
27	Manning Town South	422	33	16	120	8	177	3	0	1	42.2
28	Notikewin/North Star	469	42	8	109	10	169	0	1	0	36.2
29	Deadwood	265	33	8	86	6	133	0	0	0	50.2
30	Dixonville	382	33	16	122	9	180	0	0	0	47.1
31	Warrensville	355	35	7	116	8	166	0	0	0	46.8
32	Weberville North	196	28	4	61	7	100	0	0	0	51.0
33	Weberville South	348	36	9	132	3	180	1	0	0	51.7
34	Three Creeks	220	46	9	44	4	103	0	0	0	46.8
35	St. Isidore	356	79	9	107	4	199	0	0	0	55.9
36	Harmon Valley	153	12	5	53	4	74	0	0	0	48.4
37	Nampa East	312	41	15	89	9	154	0	0	0	49.4
38	Nampa West	217	31	9	54	4	98	0	0	0	45.2
39	Marie Reine	217	35	8	66	3	112	0	0	0	51.6
40	Norglen East	343	60	12	89	3	164	0	0	0	47.8
41	Norglen	361	53	14	124	1	192	0	0	1	53.5
42	Springfield East	391	26	12	55	2	95	0	0	0	24.3
43	Springfield	366	49	8	116	1	174	0	0	0	47.5
44	Cloverleaf	341	51	10	87	9	157	0	0	0	46.0
45	Town Center	295	21	8	48	0	77	0	0	0	26.1
46	Heart River	381	39	13	112	4	168	0	0	0	44.1
47	Heart River South	328	45	15	87	2	149	0	0	0	45.4
48	Shaftesbury	388	62	12	110	5	189	0	0	0	48.7
49	Saddleback	397	48	8	110	1	167	0	0	0	42.1
50	Misery Mountain	329	33	9	77	5	124	0	0	1	38.0
51	Advance - Peace River	0	24	6	62	1	93	0	0	0	
52	Advance - High Level	0	8	4	19	1	32	1	0	0	

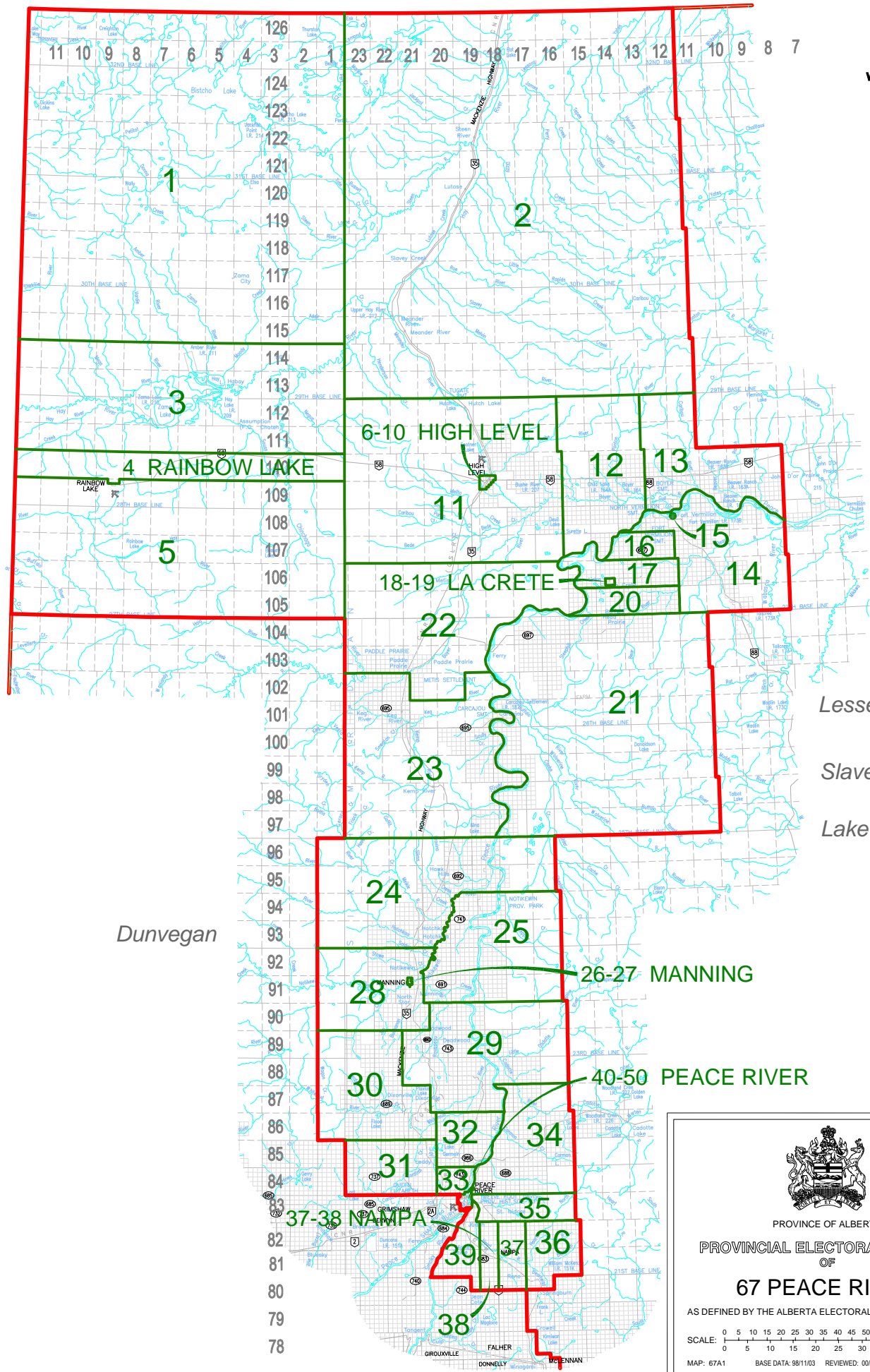
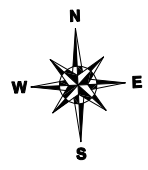

Dunvegan

Lesser
Slave
Lake

PROVINCE OF ALBERTA
PROVINCIAL ELECTORAL DIVISION
OF
67 PEACE RIVER
AS DEFINED BY THE ALBERTA ELECTORAL DIVISIONS ACT, 1996

SCALE: 0 5 10 15 20 25 30 35 40 45 50 55 60 65 70 kilometres
0 5 10 15 20 25 30 35 40 miles

MAP: 67A1 BASE DATA: 98/1103 REVIEWED: 00/03/01 PSD REVISED: 00/03/01 (POLLING SUBDIVISION)

MUNICIPAL BOUNDARY



N.W.1/4 SEC.6-110-19-5

N.E.1/4 SEC.6-110-19-5

N.W.1/4 SEC.5-110-19-5

N.E.1/4 SEC.5-110-19-5

N.W.1/4 SEC.4-110-19-5

NE1/4 SEC.4-110-19-5

N.W.1/4 SEC.3-110-19-5

9

S.W.1/4 SEC.6-110-19-5

SE1/4 SEC.6-110-19-5

SE1/4 SEC.4-110-19-5

S.W.1/4 SEC.3-110-19-5

100 AVENUE

107 AVE

103 STREET

105 AVENUE

89 STREET

HIGHWAY 35

10

N.W.1/4 SEC.31-109-19-5

NE1/4 SEC.31-109-19-5

N.W.1/4 SEC.33-109-19-5

N.E.1/4 SEC.33-109-19-5

6

S.W.1/4 SEC.31-109-19-5

S.E.1/4 SEC.31-109-19-5

S.W.1/4 SEC.33-109-19-5

N.W.1/4 SEC.30-109-19-5

N.E.1/4 SEC.30-109-19-5

TOWN OF HIGH LEVEL

MUNICIPAL BOUNDARY

S.W.1/4 SEC.30-109-19-5

SE1/4 SEC.30-109-19-5

S.W.1/4 SEC.29-109-19-5



PROVINCE OF ALBERTA

PROVINCIAL ELECTORAL DIVISION
OF

67 PEACE RIVER

AS DEFINED BY THE ALBERTA ELECTORAL DIVISIONS ACT, 1996

SCALE: 0 100 200 300 400 500 600 700 800 900 1000 metres
0 500 1000 1500 2000 2500 3000 feet

MAP: 67B1 BASE DATA: 00/07/03 REVIEWED: 00/03/01 PSD REVISED: 99/03/01
(POLLING SUBDIVISION)

MUNICIPAL BOUNDARY

ROADWAY

ROADWAY



18

19

100 AVENUE

99 STREET

100 STREET

MUNICIPAL BOUNDARY

MUNICIPAL BOUNDARY

HAMLET OF LA CRETE



PROVINCE OF ALBERTA

PROVINCIAL ELECTORAL DIVISION
OF

67 PEACE RIVER

AS DEFINED BY THE ALBERTA ELECTORAL DIVISIONS ACT, 1996

SCALE: 0 100 200 300 400 500 600 metres
0 500 1000 1500 2000 feet

MAP: 67C1 BASE DATA: 00/07/03 REVIEWED: 00/03/01 PSD REVISED: 99/03/01
(POLLING SUBDIVISION)

MUNICIPAL BOUNDARY

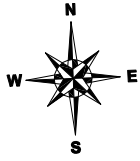

W33 91-23-5

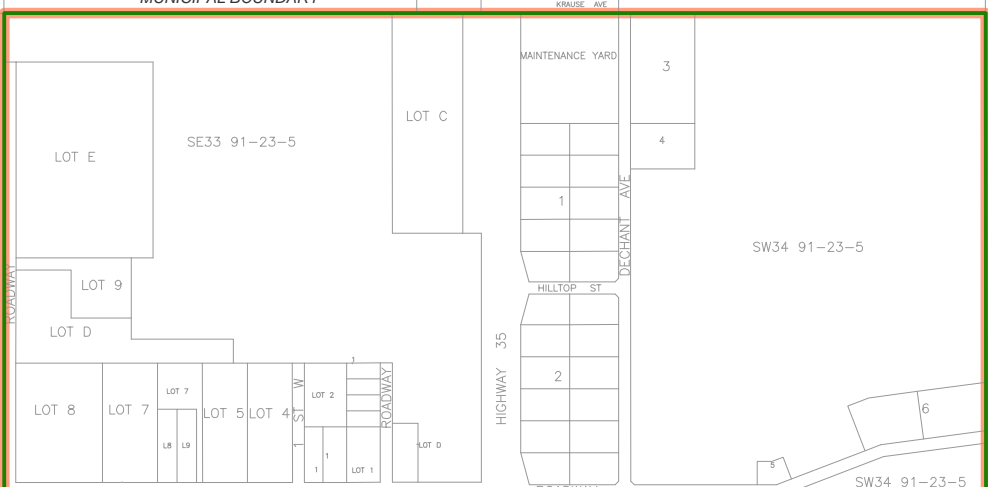

26

27

NOTKEWIN RIVER

NOTKEWIN RIVER



TOWN OF MANNING



PROVINCE OF ALBERTA
 PROVINCIAL ELECTORAL DIVISION
 OF
67 PEACE RIVER
 AS DEFINED BY THE ALBERTA ELECTORAL DIVISIONS ACT, 1996

SCALE: 0 50 100 150 200 250 300 350 400 450 500 metres
 0 200 400 600 800 1000 1200 1400 1600 feet

MAP: 67D1 BASE DATA: 00/07/03 REVIEWED: 00/03/01 PSD REVISED: 99/03/01 (POLLING SUBDIVISION)

MUNICIPAL BOUNDARY

81-21-5

NE24 81-21-5

NW24

8

CANADIAN NATIONAL RAILWAY
CANADIAN NATIONAL RAILWAY
CANADIAN NATIONAL RAILWAY

7

7

LOT A

LOT C

38

NE24 81-21-5

5

100

100

99

99

99

98

LOT A

13

10

10

10

10

10

10

10

10

10

10

10

10

10

97

97

101

101

96

96

96

96

HIGHWAY ST

MAIN ST

10

R2

SEWAGE LAGOON SITE

1

NW19 81-20-5

LOT B

37

NW19 81-20-5

CANADIAN NATIONAL RAILWAY

NW19 81-20-5

100 STREET

100

100

100

100

100

100

100

102

102

102

102

102

102

102

102

102

102

102

102

102

102

102

102

102

102

102

102

102

102

102

102

102

102

102

102

102

102

6

6

6

6

6

6

6

6

6

6

6

6

6

6

6

6

6

6

6

6

6

6

6

6

6

6

6

6

6

6

9

9

9

9

9

9

9

9

9

9

9

9

9

9

9

9

9

9

9

9

9

9

9

9

9

9

9

9

9

9

2

2

2

2

2

2

2

2

2

2

2

2

2

2

2

2

2

2

2

2

2

2

2

2

2

2

2

2

2

2

3

3

3

3

3

3

3

3

3

3

3

3

3

3

3

3

3

3

3

3

3

3

3

3

3

3

3

3

3

3

4

4

4

4

4

4

4

4

4

4

4

4

4

4

4

4

4

4

4

4

4

4

4

4

4

4

4

4

4

4

5

5

5

5

5

5

5

5

5

5

5

5

5

5

5

5

5

5

5

5

5

5

5

5

5

5

5

5

5

5

6

6

6

6

6

6

6

6

6

6

6

6

6

6

6

6

6

6

6

6

6

6

6

6

6

6

6

6

6

6

7

7

7

7

7

7

7

7

7

7

7

7

7

7

7

7

7

7

7

7

7

7

7

7

7

7

7

7

7

7

8

8

8

8

8

8

8

8

8

8

8

8

8

8

8

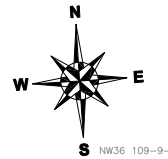

MUNICIPAL BOUNDARY

MUNICIPAL BOUNDARY

MUNICIPAL BOUNDARY

HIGHWAY 58

4

5

5

5

TOWN OF RAINBOW LAKE



PROVINCE OF ALBERTA

PROVINCIAL ELECTORAL DIVISION
OF

67 PEACE RIVER

AS DEFINED BY THE ALBERTA ELECTORAL DIVISIONS ACT, 1996

SCALE: 0 100 200 300 400 500 600 700 metres
0 500 1000 1500 2000 feet

MAP: 67G1 BASE DATA: 00/07/03 REVIEWED: 00/03/01 PSD REVISED: 00/03/01
(POLLING SUBDIVISION)

