

**Electoral Division of Stony Plain
Statement of Official Results - March 12, 2001**

POLL NUMBER	NAME OF POLL	NAMES ON LIST	MONIKA CAPPIS LIB	STEPHEN LINDOP NDP	STAN WOLOSHYN PC	V	S	D	R	% VOTER TURNOUT
1	Entwistle Magnolia	356	62	24	132	218	0	0	0	61.2
2	Entwistle South	258	24	12	87	123	0	0	0	47.7
3	Gainford Fallis	376	58	31	131	220	2	0	0	58.5
4	Seba Beach	386	74	21	152	247	1	0	0	64.0
5	Wabamun North	308	54	25	124	203	1	0	0	65.9
6	Wabamun Village	476	80	36	166	282	0	1	6	60.7
7	Clear Lake	282	45	23	93	161	0	0	0	57.1
8	Smithfield	296	25	13	90	128	0	0	0	43.2
9	Manly	312	46	15	116	177	1	0	0	56.7
10	Blueberry West	553	61	17	187	265	1	0	0	47.9
11	Blueberry	477	66	31	177	274	2	0	0	57.4
12	Blueberry East	289	50	15	116	181	0	0	0	62.6
13	Hubbles Lake	395	56	36	164	256	1	2	0	65.3
14	Hubbles Lake North	236	25	2	108	135	0	0	0	57.2
15	Chickakoo	411	60	13	172	245	0	0	2	60.1
16	Hubbles Lake North West	223	31	8	70	109	0	0	0	48.9
17	Chickakoo North	532	64	17	211	292	1	0	0	54.9
18	Panorama Heights	386	44	19	153	216	1	0	0	56.0
19	Muir Lake	391	59	13	147	219	0	0	0	56.0
20	Westbrook	223	22	8	62	92	0	0	0	41.3
21	Spruce Grove North	339	38	3	137	178	0	0	0	52.5
22A	Stony Plain West (North)	311	25	13	109	147	1	0	0	47.3
22B	Stony Plain West (South)	292	43	24	96	163	0	0	0	55.8
23	Stony Plain Southwest	478	59	13	160	232	0	0	0	48.5
24	Stony Glens	426	71	17	130	218	0	0	0	51.2
25	Stony Central	368	40	19	152	211	1	0	0	57.3
26	Meridian Heights West	255	23	13	102	138	0	0	0	54.1
27	Boulder	415	43	20	120	183	0	0	0	44.1
28	Meridian Central	333	42	10	78	130	0	0	1	39.3
29	Meridian West	496	58	23	154	235	0	0	3	48.0
30	Forest Green North	377	34	17	114	165	0	0	0	43.8
31	Forest Green	489	33	20	167	220	0	0	0	45.0
32	Forest Green West	387	39	20	137	196	1	0	0	50.6
33	Southridge	371	66	14	121	201	1	0	0	54.2
34	Southridge South	451	69	20	180	269	0	0	1	59.9
35	Fairway Sunrise	351	40	13	146	199	2	0	0	56.7
36	High Park	423	44	21	182	247	0	0	0	58.4
37	Spruce Grove South	456	76	28	158	262	0	0	1	57.7
38	Spruce Grove South East	450	62	15	163	240	0	0	0	53.3
39	Enoch I.R.	388	19	3	108	130	2	0	0	33.5
40	Clymont North East	473	58	35	211	304	0	0	1	64.5
41	Westridge	516	47	25	230	302	1	0	0	58.5
42	Clymont South	544	84	51	180	315	0	0	0	57.9
43	Clymont North West	496	81	40	190	311	0	0	0	62.7
44	Clymont South West	279	38	21	100	159	1	0	0	57.0
45	Graminia North West	340	30	17	133	180	0	1	0	53.2
46	Graminia	295	38	15	139	192	0	0	1	65.4
47	Deer Park	201	45	14	68	127	0	0	0	63.2
48	Sandhills	447	65	30	150	245	0	0	0	54.8
49	Garden Valley	374	37	18	155	210	0	0	0	56.1
50	Golden Spike	271	46	12	124	182	0	0	0	67.2
51	Holborn	431	56	24	183	263	0	0	0	61.0
52	Rosenthal	501	73	24	222	319	0	0	0	63.7

**Electoral Division of Stony Plain
Statement of Official Results - March 12, 2001**

POLL NUMBER	NAME OF POLL	NAMES ON LIST	MONIKA CAPPIS LIB	STEPHEN LINDOP NDP	STAN WOLOSHYN PC	V	S	D	R	% VOTER TURNOUT
53	Edmonton Beach	456	51	24	136	211	1	0	0	46.3
54	Carvel	362	57	21	115	193	0	0	0	53.3
55	Carvel South	517	55	23	171	249	0	0	0	48.2
56	Brightbank	388	68	22	172	262	0	0	1	67.8
57	Duffield	410	52	28	152	232	1	0	0	56.6
58	Paul Band I.R.	199	1	2	20	23	0	0	0	11.6
59	Keephills	210	19	17	105	141	1	0	0	67.1
60	Horen	214	26	14	100	140	0	0	1	65.9
61	Tomahawk	358	59	15	145	219	0	0	1	61.5
62	Moon Lake	364	31	18	140	189	0	0	0	51.9
63	Advance	0	128	39	332	499	0	0	1	
64	Mobile - George Hennig/ Stony Plain Hosp./Whispering Water	0	12	3	64	79	0	0	0	
65	Special Ballot	0	41	4	88	133	0	0	4	
TOTAL		23,668	3,228	1,261	9,197	13,686	24	4	24	57.9

V = Valid Ballots S = Spoiled Ballots D = Declined Ballots R = Rejected Ballots

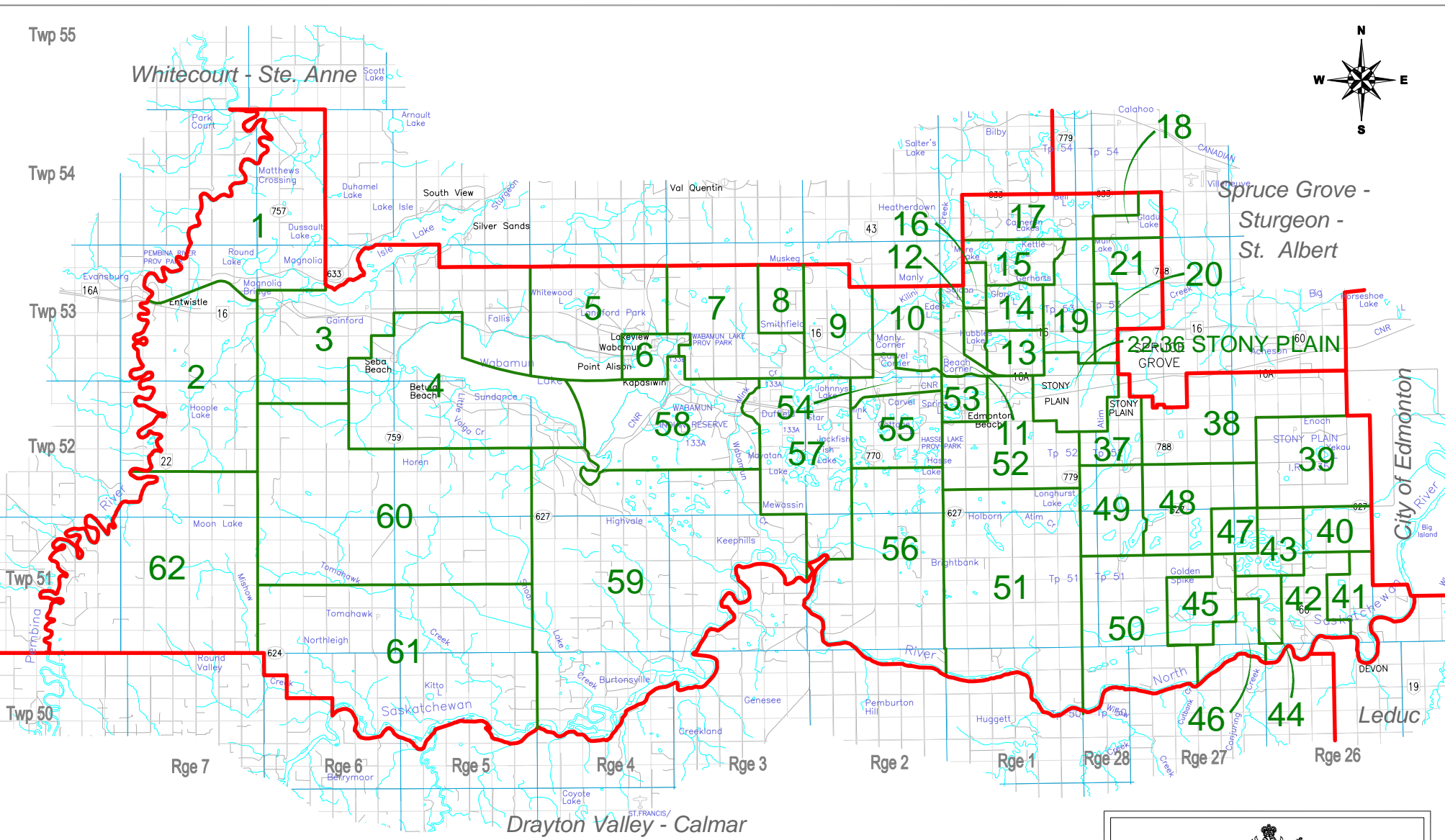
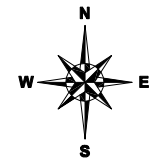

PROVINCE OF ALBERTA

PROVINCIAL ELECTORAL DIVISION
OF

76 STONY PLAIN

AS DEFINED BY THE ALBERTA ELECTORAL DIVISIONS ACT, 1996

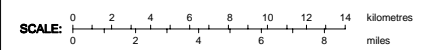

MAP: 76A1 BASE DATA: 98/11/03 REVIEWED: 00/09/15 PSD REVISED: 00/09/29
(POLLING SUBDIVISION)



MUNICIPAL BOUNDARY

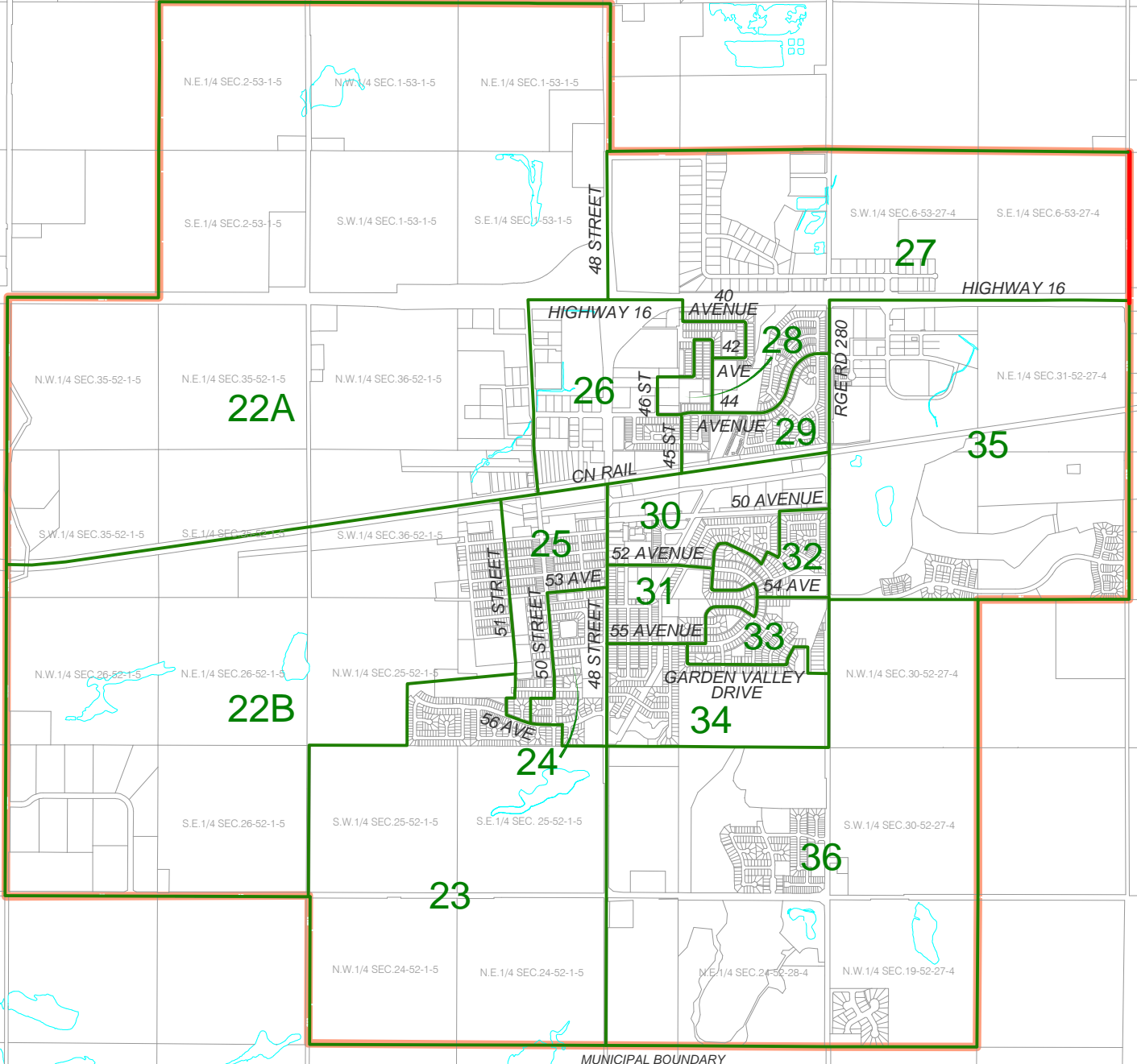

TOWN OF STONY PLAIN



PROVINCE OF ALBERTA

PROVINCIAL ELECTORAL DIVISION
OF

76 STONY PLAIN

AS DEFINED BY THE ALBERTA ELECTORAL DIVISIONS ACT, 1996

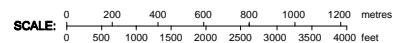

MAP: 76B1 BASE DATA: 00/07/03 REVIEWED: 00/09/15 PSD REVISED: 00/09/29
(POLLS SUBDIVISION)

**Electoral Division of Strathmore-Brooks
Statement of Official Results - March 12, 2001**

POLL NUMBER	NAME OF POLL	NAMES ON LIST	DON MACFARLANE NDP	RUDY MARTENS SC	BARRY MORISHITA LIB	LYLE OBERG PC	CHRISTOPHER SUTHERLAND IND	V	S	D	R	% VOTER TURNOUT
1	Lyalta	491	15	2	17	181	9	224	0	0	0	45.6
2	Strathmore Rural North	411	7	2	11	161	12	193	0	0	0	47.0
3	Strathmore Aspen Creek	312	6	1	18	141	3	169	0	0	0	54.2
4	Strathmore Downtown South	494	11	7	16	137	2	173	1	0	0	35.0
5	Strathmore Westmount	448	8	3	29	189	1	230	0	1	0	51.6
6	Strathmore Downtown North	457	3	1	14	127	3	148	0	0	0	32.4
7	Strathmore Thorncliff	475	10	2	24	175	4	215	0	0	0	45.3
8	Strathmore Parkwood	479	10	0	28	195	1	234	0	0	0	48.9
9	Strathmore Greenmeadows	358	8	4	24	119	0	155	0	0	1	43.6
10	Strathmore Cambria	427	9	3	25	180	5	222	0	1	0	52.2
11	Strathmore Brentwood	363	6	1	24	162	3	196	0	0	0	54.0
12	Strathmore Briar	322	5	3	11	125	12	156	0	0	0	48.4
13	Strathmore Maplewood North	338	5	0	16	129	3	153	0	0	0	45.3
14	Strathmore Strathaven	446	9	6	28	181	3	227	0	0	1	51.1
15	Strathmore Rural North East	519	5	5	9	216	19	254	0	0	0	48.9
16	Standard	537	5	16	19	299	17	356	0	0	0	66.3
17	Hussar	539	3	1	11	235	10	260	1	0	0	48.2
18	Gem	193	3	1	19	112	6	141	0	0	0	73.1
19	Bassano Rural	434	1	6	21	103	12	143	0	0	0	32.9
20	Gleichen	506	18	3	28	224	14	287	0	0	0	56.7
21	Namaka	538	6	5	19	224	6	260	0	0	1	48.5
22	Carseland Rural	419	5	0	22	156	11	194	0	0	0	46.3
23	Carseland Town	413	9	11	13	186	3	222	0	0	0	53.8
24A	Siksika South West	304	2	0	12	32	0	46	0	0	0	15.1
24B	Siksika West	622	7	2	19	92	1	121	0	0	0	19.5
24C	Siksika Centre	346	3	0	5	44	1	53	0	0	1	15.6
25	Siksika East	386	4	0	6	49	2	61	0	0	0	15.8
26	Bassano South	241	5	5	31	100	15	156	0	0	0	64.7
27	Bassano North	277	2	1	26	109	8	146	0	0	1	53.1
28	Bassano East	320	5	2	19	99	13	138	0	0	0	43.1
29	Rosemary Rural	362	0	5	22	122	14	163	0	0	0	45.0
30	Rosemary Town	223	2	10	28	86	3	129	0	0	1	58.3
31	Duchess Rural	355	0	3	35	113	21	172	0	0	1	48.7
32	Duchess Urban	529	1	13	34	183	16	247	0	0	0	46.7
33	Patricia	323	2	3	29	111	11	156	0	0	0	48.3
34	Cassils	257	3	2	18	117	5	145	0	0	0	56.4

**Electoral Division of Strathmore-Brooks
Statement of Official Results - March 12, 2001**

POLL NUMBER	NAME OF POLL	NAMES ON LIST	DON MACFARLANE NDP	RUDY MARTENS SC	BARRY MORISHITA LIB	LYLE OBERG PC	CHRISTOPHER SUTHERLAND IND	V	S	D	R	% VOTER TURNOUT
35	Brooks Rural North	395	1	3	33	117	12	166	0	0	0	42.0
36	Brooks Rural North East	351	1	2	29	123	13	168	0	0	0	47.9
37	Brooks Uplands	416	2	4	39	108	2	155	0	0	0	37.3
38	Brooks Stafford	383	2	4	2	39	7	54	0	0	0	14.1
39	Brooks Prairie Meadows	496	3	10	69	141	8	231	0	0	0	46.6
40	Brooks Garrow	274	0	2	14	48	1	65	0	0	1	24.1
41	Brooks Fairview	366	5	4	42	102	3	156	0	0	0	42.6
42	Brooks Kellington Ludor	305	3	5	37	110	2	157	0	0	0	51.5
43	Brooks Parkland	474	4	3	64	158	13	242	0	0	0	51.1
44	Brooks Greenbrook	378	2	4	42	93	4	145	0	0	0	38.4
45	Brooks Greenbrook Mobile Park	313	3	1	15	30	2	51	0	0	1	16.6
46	Brooks Eastbrook	380	3	1	31	93	6	134	0	0	0	35.3
47	Brooks Centre	434	3	9	41	88	7	148	0	0	0	34.1
48	Brooks Griffin Park	502	6	8	38	142	6	200	0	0	0	39.8
49	Brooks Westbrook	422	3	6	40	124	12	185	0	0	1	44.1
50	Brooks West End	415	2	5	42	86	5	140	0	0	0	33.7
51	Brooks Sunnylea	527	0	8	30	115	7	160	0	0	0	30.4
52	Brooks Charlesworth	360	2	5	47	88	3	145	0	0	0	40.3
53	Brooks Ingram	407	0	2	25	58	2	87	0	0	0	21.4
54	Brooks McNab Meadow Lake	488	3	3	67	142	14	229	0	0	0	46.9
55	Tilley North	321	7	8	36	96	5	152	0	0	0	47.4
56	Brooks Rural South	545	1	7	61	187	20	276	0	0	0	50.6
57	Rainier/Scandia	368	2	3	28	128	21	182	0	1	0	49.7
58	Tilley South	250	2	8	24	102	16	152	0	0	0	60.8
59	Rolling Hills	338	3	10	31	164	9	217	0	0	0	64.2
60	Advance - Bassano	0	0	0	4	38	5	47	0	0	0	
61	Advance - Brooks	0	4	5	45	181	17	252	0	0	1	
62	Advance - Strathmore	0	9	2	18	173	5	207	0	0	0	
63	Mobile - Bassano	0	1	1	3	24	2	31	0	0	0	
64	Mobile - Brooks	0	5	6	28	114	6	159	0	0	2	
65	Mobile - Strathmore	0	4	5	17	115	5	146	1	0	0	
66	Special Ballot	0	1	0	2	44	2	49	0	0	10	
TOTAL		24,372	290	273	1,774	8,585	511	11,433	3	3	23	47.0

V = Valid Ballots S = Spoiled Ballots D = Declined Ballots R = Rejected Ballots

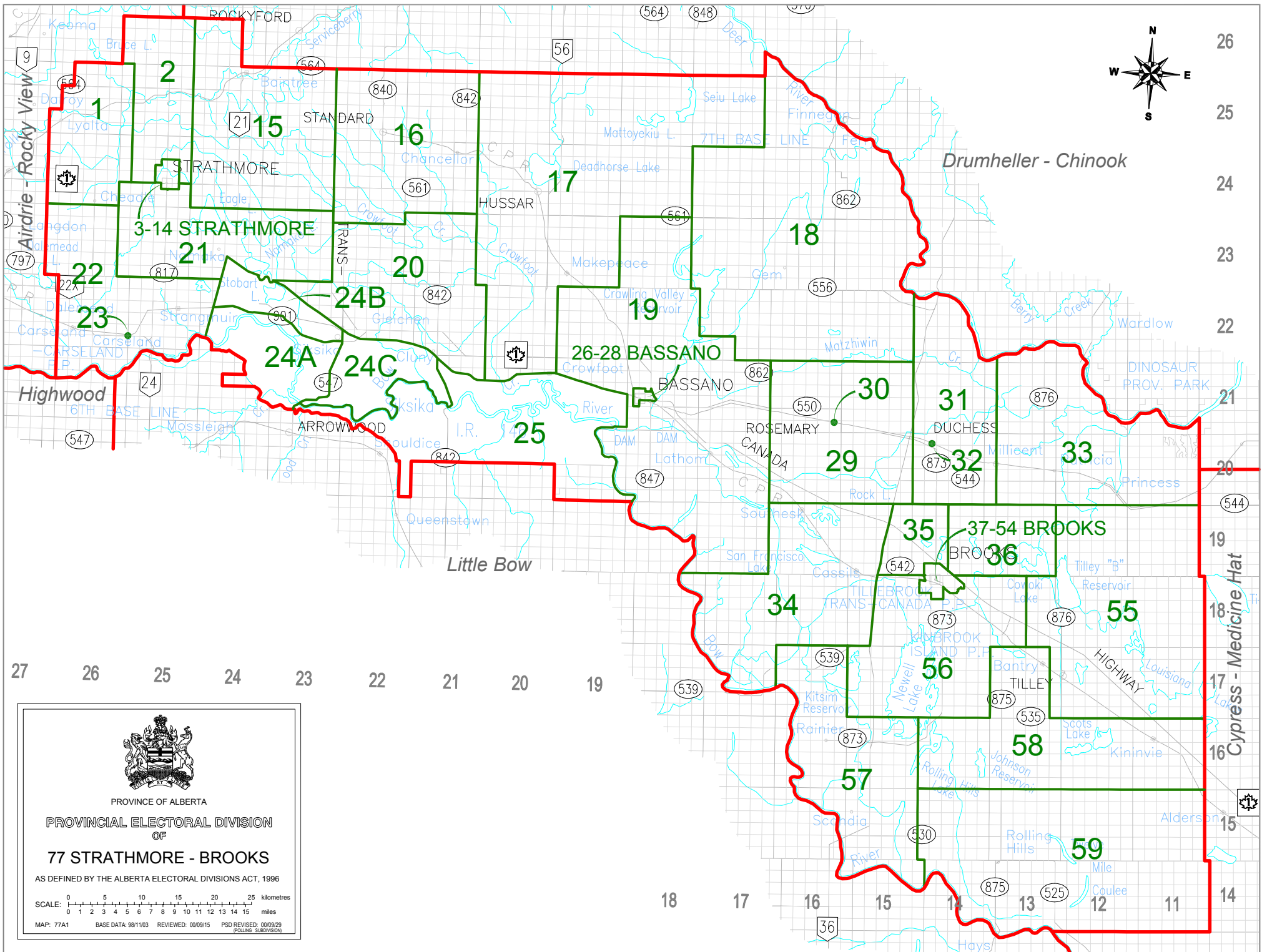

PROVINCE OF ALBERTA

PROVINCIAL ELECTORAL DIVISION
OF

77 STRATHMORE - BROOKS

AS DEFINED BY THE ALBERTA ELECTORAL DIVISIONS ACT, 1996

SCALE: 0 5 10 15 20 25 kilometres
0 1 2 3 4 5 6 7 8 9 10 11 12 13 14 15 miles

MAP: 77A1 BASE DATA: 98/1103 REVIEWED: 00/09/15 PSD REVISED: 00/09/23
(POLLING SUBDIVISION)



PROVINCE OF ALBERTA
 PROVINCIAL ELECTORAL DIVISION
 OF
77 STRATHMORE - BROOKS

AS DEFINED BY THE ALBERTA ELECTORAL DIVISIONS ACT, 1996

SCALE: 0 100 200 300 400 500 600 700 800 900 1000 metres
 0 500 1000 1500 2000 2500 3000 feet

MAP: 77C1 BASE DATA: 00/07/03 REVIEWED: 00/03/01 PSD REVISED: 00/03/01
 POLLING SUBDIVISION

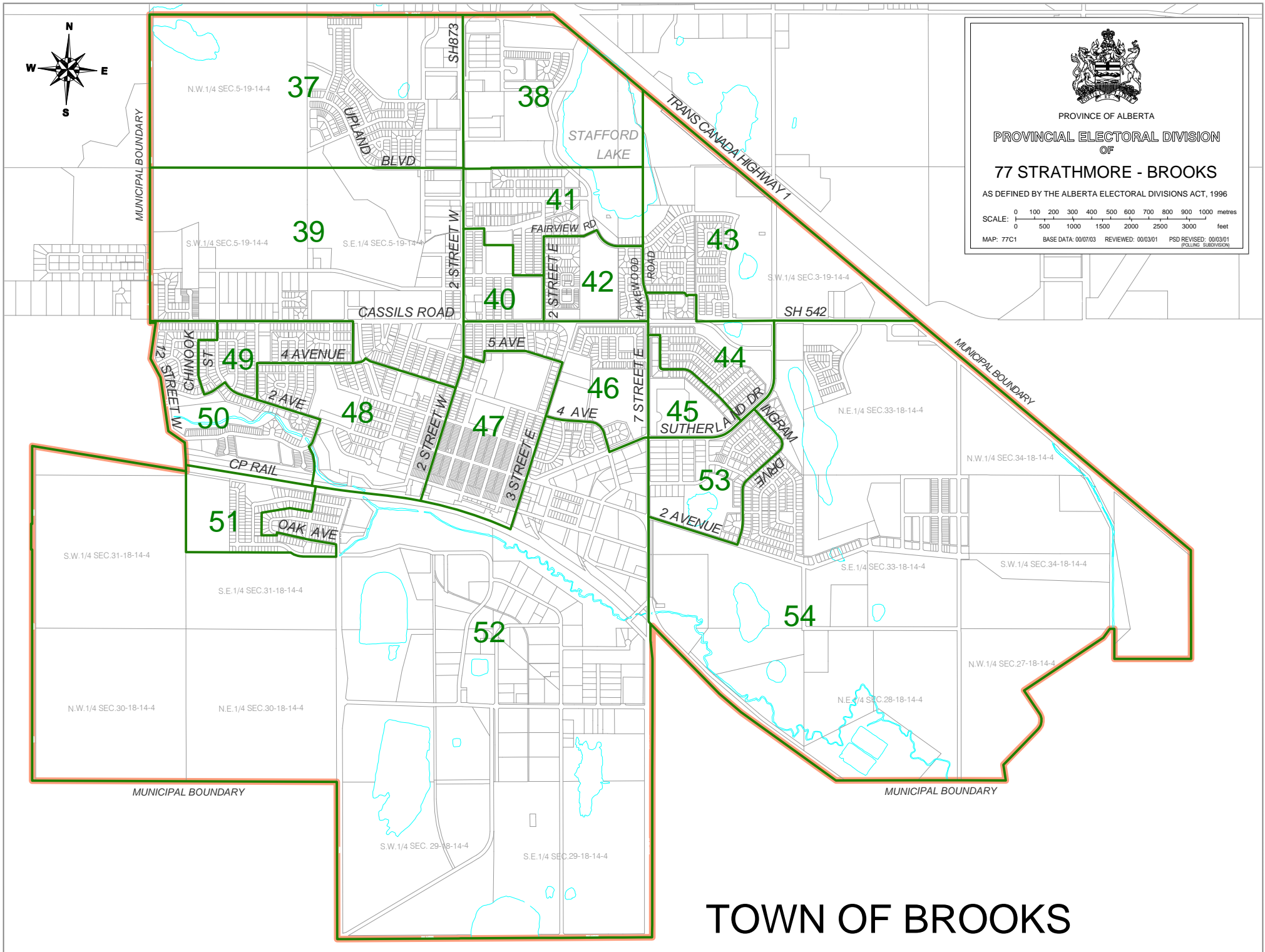

TOWN OF BROOKS

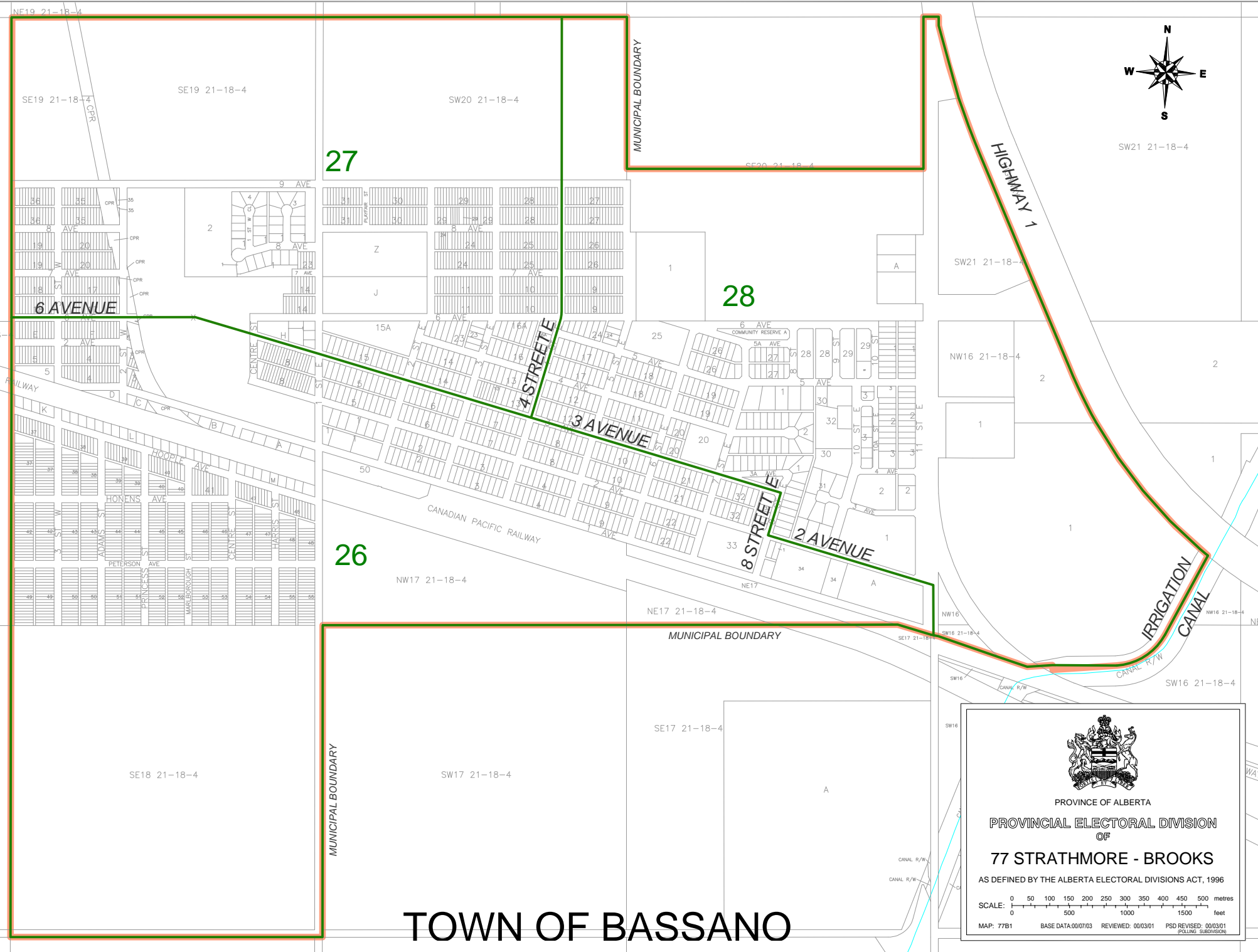
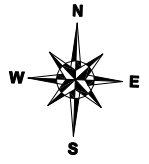

27

28

26

TOWN OF BASSANO



PROVINCE OF ALBERTA
PROVINCIAL ELECTORAL DIVISION
OF

77 STRATHMORE - BROOKS

AS DEFINED BY THE ALBERTA ELECTORAL DIVISIONS ACT, 1996

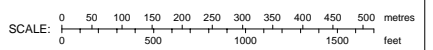

MAP: 77B1 BASE DATA: 00/07/03 REVIEWED: 00/03/01 PSD REVISED: 00/03/01 (POLLING SUBDIVISION)

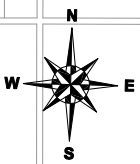

MUNICIPAL BOUNDARY

12

N.W. 1/4 SEC. 23-24-25-4

13

14

BRENT BOULEVARD

BRIARWOOD RD

BAY RD

MAPLEWOOD DR

BRENTWOOD DR E

11

S.E. 1/4 SEC. 22-24-25-4

10

WHEATLAND TRAIL

EASTLAKE ROAD

WHEATLEAF RD

CANTONIA ROAD

CP RAIL

7

9

GREEN MEADOWS

8

CP RAIL

PARKLINE DR

6

WESTMOUNT DR

2 AVENUE

3 AVENUE

S.E. 1/4 SEC. 14-24-25-4

3

5

N.W. 1/4 SEC. 15-24-25-4

S.W. 1/4 SEC. 15-24-25-4

WESTLAKE RD

4

N.W. 1/4 SEC. 11-24-25-4

N.E. 1/4 SEC. 11-24-25-4

MUNICIPAL BOUNDARY

ROAD ALLOWANCE

MUNICIPAL BOUNDARY



PROVINCE OF ALBERTA

PROVINCIAL ELECTORAL DIVISION OF

77 STRATHMORE - BROOKS

AS DEFINED BY THE ALBERTA ELECTORAL DIVISIONS ACT, 1996

SCALE: 0 100 200 300 400 500 600 700 800 900 1000 metres
0 500 1000 1500 2000 2500 3000 3500 feet

MAP: 77D1 BASE DATA: 00/07/03 REVIEWED: 00/03/01 PSD REVISED: 00/03/01 (POLING SUBMISSION)

TOWN OF STRATHMORE

**Electoral Division of Vegreville-Viking
Statement of Official Results - March 12, 2001**

POLL NUMBER	NAME OF POLL	NAMES ON LIST	ROSS DEMKIW LIB	GREG KURULOK NDP	ED STELMACH PC	V	S	D	R	% VOTER TURNOUT
1	Skaro District	326	55	21	112	188	1	0	0	57.7
2	Bruderheim North/East	418	57	21	147	225	0	0	0	53.8
3	Bruderheim South/West	377	62	17	133	212	0	0	0	56.2
4	Bruderheim Rural	339	45	11	123	179	0	0	0	52.8
5	Lamont Rural-North/East/South	480	76	30	157	263	0	0	0	54.8
6	Lamont West	378	50	23	97	170	1	0	0	45.0
7	Lamont Central	342	65	24	127	216	0	0	0	63.2
8	Lamont East	403	74	21	164	259	0	0	0	64.3
9	Andrew Rural-North/East/West	324	59	26	121	206	0	0	1	63.9
10	Andrew	368	76	29	132	237	0	0	0	64.4
11	Andrew Rural/South	240	55	12	100	167	0	0	0	69.6
12	Willingdon and Rural	472	126	24	152	302	2	1	0	64.2
13	Willingdon	419	91	25	122	238	0	0	4	57.8
14	Two Hills Rural/North	339	62	17	120	199	1	0	0	58.7
15	Two Hills East	360	65	12	109	186	0	0	0	51.7
16	Two Hills West	359	76	26	96	198	0	0	0	55.2
17	Two Hills Rural/South	308	65	15	96	176	1	0	0	57.1
18	Lavoy and Rural	308	62	8	110	180	0	0	1	58.8
19	Vegreville Rural/North	383	73	28	109	210	0	0	0	54.8
20	Vegreville North West	445	66	42	174	282	1	0	0	63.4
21	Vegreville North East	324	59	36	76	171	0	0	1	53.1
22	Vegreville North/North East	512	119	46	150	315	0	0	0	61.5
23	Vegreville East	303	58	32	61	151	0	0	1	50.2
24	Vegreville Central	266	34	14	54	102	0	0	2	39.1
25	Vegreville West Central	313	53	28	85	166	0	0	0	53.0
26	Vegreville West	422	84	15	97	196	1	0	0	46.4
27	Vegreville South West	371	62	19	108	189	1	0	0	50.9
28	Vegreville South East	388	69	33	133	235	0	0	0	60.6
29	Vegreville South	373	94	27	122	243	1	0	0	65.1
30	Vegreville Rural/South	422	71	23	153	247	1	0	1	58.8
31	Mundare Rural/South	351	81	18	115	214	1	0	0	61.0
32	Town Of Mundare	484	94	15	133	242	0	0	0	50.0
33	Mundare Rural/North	332	81	19	110	210	0	0	3	64.2
34	Chipman and Rural	398	61	24	140	225	0	0	0	56.5
35	Chipman	385	62	22	116	200	0	0	0	51.9
36	Tofield Rural/West	226	25	17	85	127	0	0	0	56.2
37	Tofield Rural/North	487	44	38	179	261	1	0	0	53.6
38	Tofield Town/North West	399	43	22	141	206	1	0	0	51.6
39	Tofield Central	435	57	23	154	234	1	0	1	54.0
40	Tofield East	368	43	18	178	239	1	0	0	64.9
41	Tofield South West/Rural	506	50	30	123	203	0	0	1	40.3
42	Tofield Rural/South	448	39	16	180	235	1	0	0	52.5
43	Ryley Rural	334	42	12	143	197	0	0	1	59.3
44	Ryley	324	52	13	115	180	1	0	0	55.6
45	Holden Rural	397	56	15	134	205	3	0	0	51.6
46	Holden	259	44	20	74	138	0	0	0	53.3
47	Bruce and Rural	341	20	29	110	159	0	0	3	47.5
48	Viking Rural/North	319	24	15	164	203	1	0	0	63.6
49	Viking North/East	384	28	14	169	211	0	0	0	54.9
50	Viking South/West	412	35	14	189	238	0	0	1	58.0
51	Viking Rural/South	319	25	9	155	189	1	0	0	59.2
52	Kinsella and Rural	197	15	4	104	123	0	0	1	62.9
53	Advance - Two Hills	0	18	6	62	86	0	0	0	

**Electoral Division of Vegreville-Viking
Statement of Official Results - March 12, 2001**

POLL NUMBER	NAME OF POLL	NAMES ON LIST	ROSS DEMKIW LIB	GREG KURULOK NDP	ED STELMACH PC	V	S	D	R	% VOTER TURNOUT
54	Advance - Lamont	0	58	9	59	126	0	0	0	
55	Advance - Vegreville	0	50	24	120	194	0	0	4	
56	Advance - Tofield	0	9	7	49	65	0	0	1	
57	Mobile - Andrew/Lamont/ Two Hills/Willingdon	0	72	25	124	221	0	0	2	
58	Mobile - Mundare/Vegreville	0	59	37	102	198	1	0	1	
59	Mobile - Holden/Tofield/Viking	0	19	13	88	120	0	0	4	
60	Special Ballot	0	22	10	36	68	0	0	1	
TOTAL		19,187	3,391	1,243	7,191	11,825	24	1	35	61.8

V = Valid Ballots S = Spoiled Ballots D = Declined Ballots R = Rejected Ballots

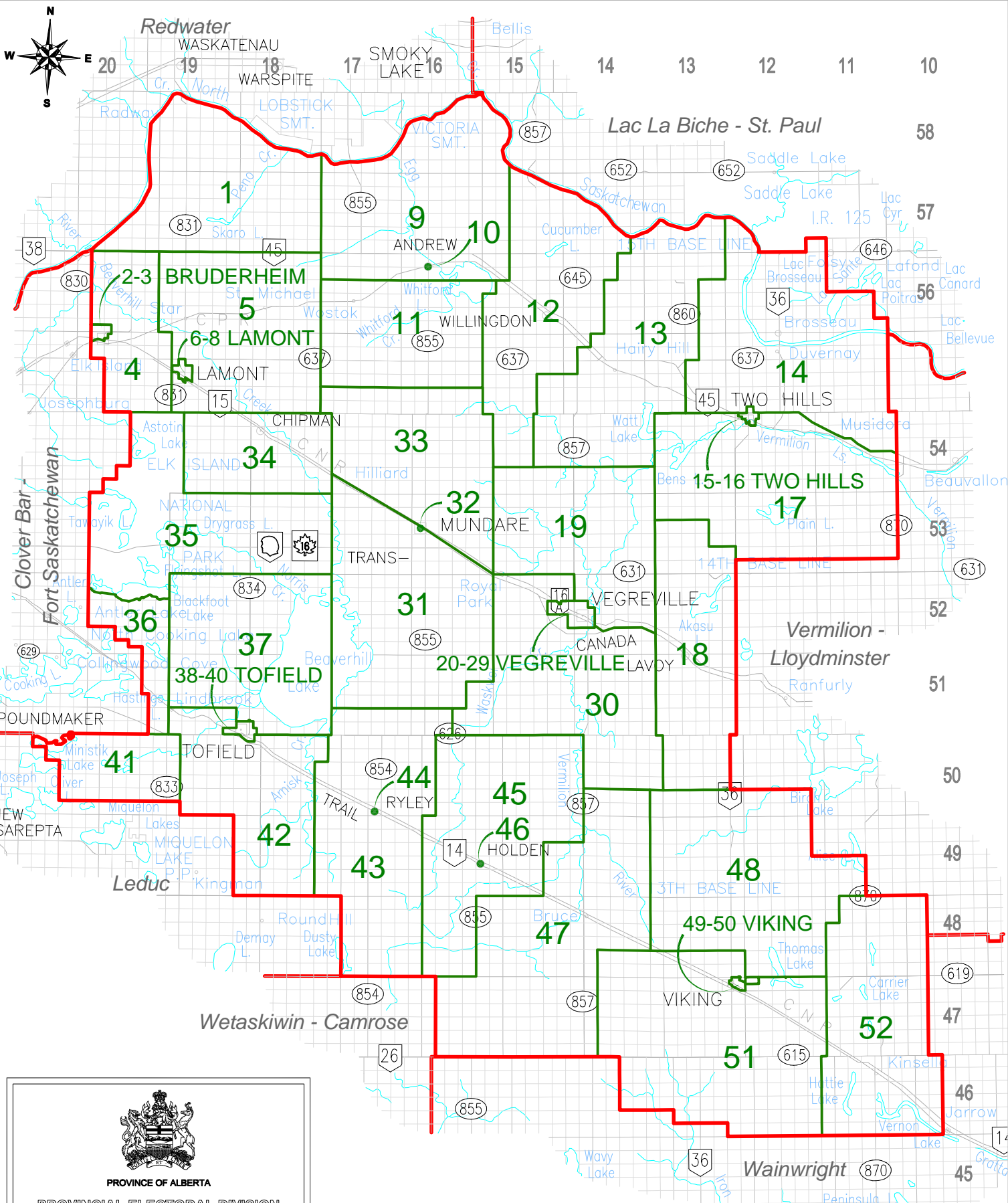

PROVINCE OF ALBERTA
 PROVINCIAL ELECTORAL DIVISION
 OF
78 VEGREVILLE - VIKING
 AS DEFINED BY THE ALBERTA ELECTORAL DIVISIONS ACT, 1996

SCALE: 0 2 4 6 8 10 12 14 16 18 20 22 24 kilometres
 0 2 4 6 8 10 12 14 miles

MAP: 78A1 BASE DATA: 98/11/03 REVIEWED: 00/03/01 PSD REVISED: 00/03/01 (POLING SUBMISSION)

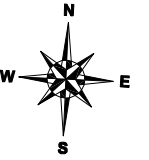

MUNICIPAL BOUNDARY

NW23 52-15-4

NE23 52-15-4

N.W. 1/4 SEC.24-52-15-4

N.E. 1/4 SEC.24-52-15-4

N.W.1/4 SEC.19-52-14-4

26

20

50 STREET

61 AVENUE

SW23 52-15-4

SE23 52-15-4

N.W. 1/4 SEC.24-52-15-4

S.E. 1/4 SEC.24-52-15-4

57

21

22

HIGHWAY 16

60 STREET

63 AVENUE

51 STREET

49 STREET

AVENUE

49 AVENUE

25

55 AVENUE

MUNICIPAL BOUNDARY

N.E. 1/4 SEC.13-52-15-4

60 STREET

46 AVENUE

27

50 STREET

54A AVENUE

24

23

CN RAIL

47 STREET

45 AVENUE

49 AVENUE

MUNICIPAL BOUNDARY

S.E. 1/4 SEC.13-52-15-4

52 STREET

43 AVENUE

29

28

S.W. 1/4 SEC. 7-52-14-4

41 AVENUE

47 STREET



PROVINCE OF ALBERTA

PROVINCIAL ELECTORAL DIVISION
OF

78 VEGREVILLE - VIKING

AS DEFINED BY THE ALBERTA ELECTORAL DIVISIONS ACT, 1996

SCALE: 0 100 200 300 400 500 600 700 800 900 metres
0 500 1000 1500 2000 2500 3000 feet

MAP: 78F1 BASE DATA: 00/07/03 REVIEWED: 00/03/01 PSD REVISED: 99/03/01
(POLLING SUBDIVISION)

TOWN OF VEGREVILLE

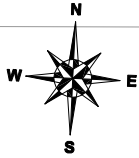

MUNICIPAL BOUNDARY

SE5 55-12-4

5-12-4

SW5 55-12-4

LOT A1

SW4 55-12-4

SE4 55-12-4

WAYSIDE CAMPSITE

2

1

LOT 1

LOT B1

HIGHWAY 45

HIGHWAY 45

LOT 1

1

23

16

NE31 54-12-4

49 STREET

15

MUNICIPAL BOUNDARY

LOT A

NE32 54-12-4

MUNICIPAL BOUNDARY

NW31 54-12-4

LOT 2

15

50 AVENUE

SW31 54-12-4

SE31 54-12-4

SE31

SE31

SE31

SE31

SE31

SE31

SE31

SE31

SE31

SE31

SE31

SE31

SE31

SE31

SE31

SE31

SE31

SE31

SE31

SE31

SE31

SE31

SE31

SE31

SE31

SE31

SE31

SE31

SE31

SE31

SE31

SE31

SE31

SE31

SE31

SE31

SE31

TOWN OF TWO HILLS



PROVINCE OF ALBERTA

PROVINCIAL ELECTORAL DIVISION
OF

78 VEGREVILLE - VIKING

AS DEFINED BY THE ALBERTA ELECTORAL DIVISIONS ACT, 1996

SCALE: 0 50 100 150 200 250 300 350 400 450 500 metres
0 200 400 600 800 1000 1200 1400 1600 feet

MAP: 78E1 BASE DATA: 00/07/03 REVIEWED: 00/03/01 PSD REVISED: 99/03/01 (POLLING SUBDIVISION)

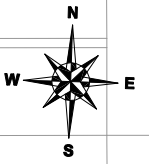

MUNICIPAL BOUNDARY

38

40

39

TOWN OF TOFIELD



PROVINCE OF ALBERTA

PROVINCIAL ELECTORAL DIVISION
OF

78 VEGREVILLE - VIKING

AS DEFINED BY THE ALBERTA ELECTORAL DIVISIONS ACT, 1996

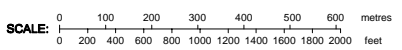

MAP: 78D1 BASE DATA: 00/07/03 REVIEWED: 00/03/01 PSD REVISED: 99/03/01
(POLLING SUBDIVISION)

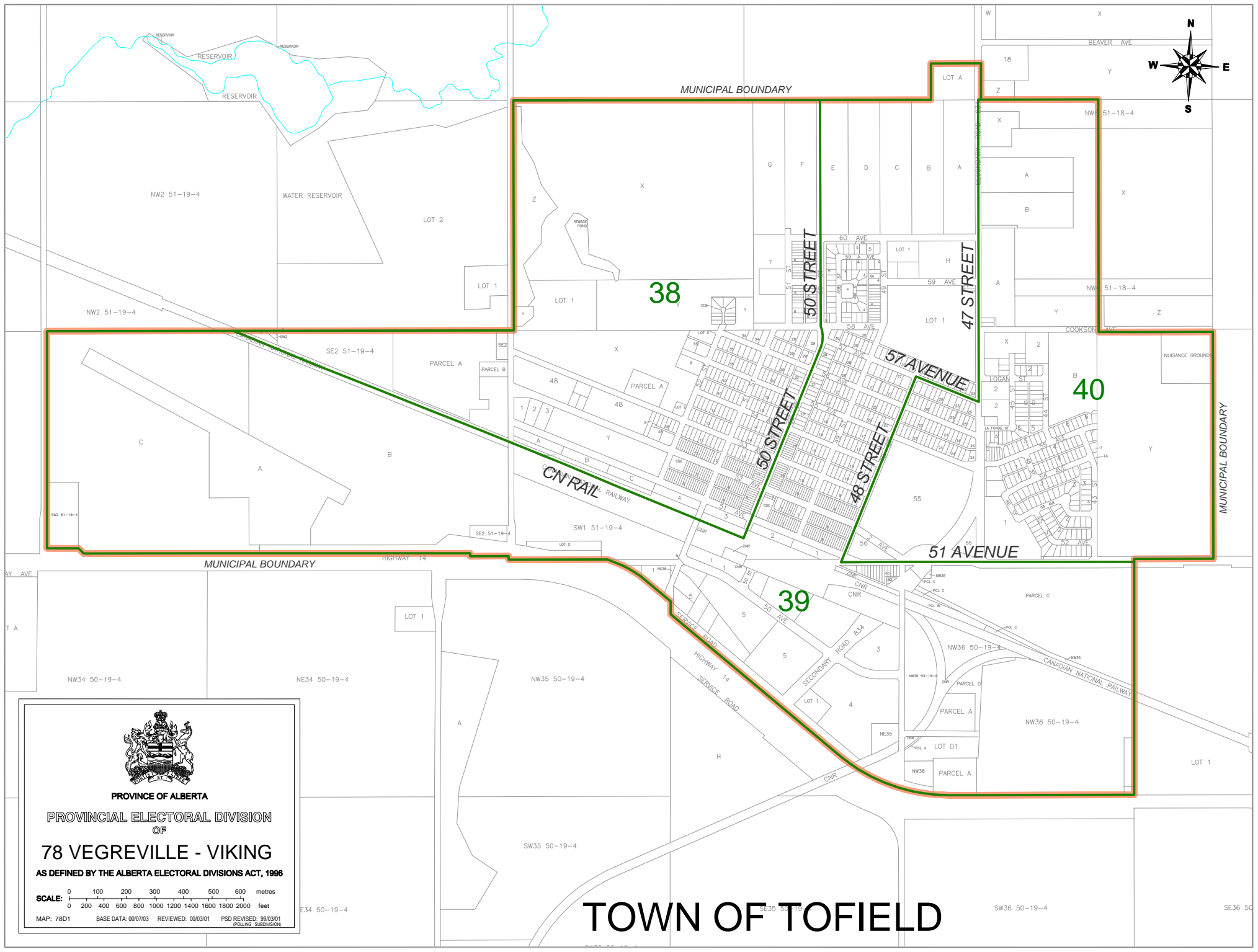

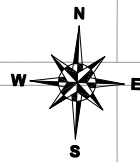

MUNICIPAL BOUNDARY

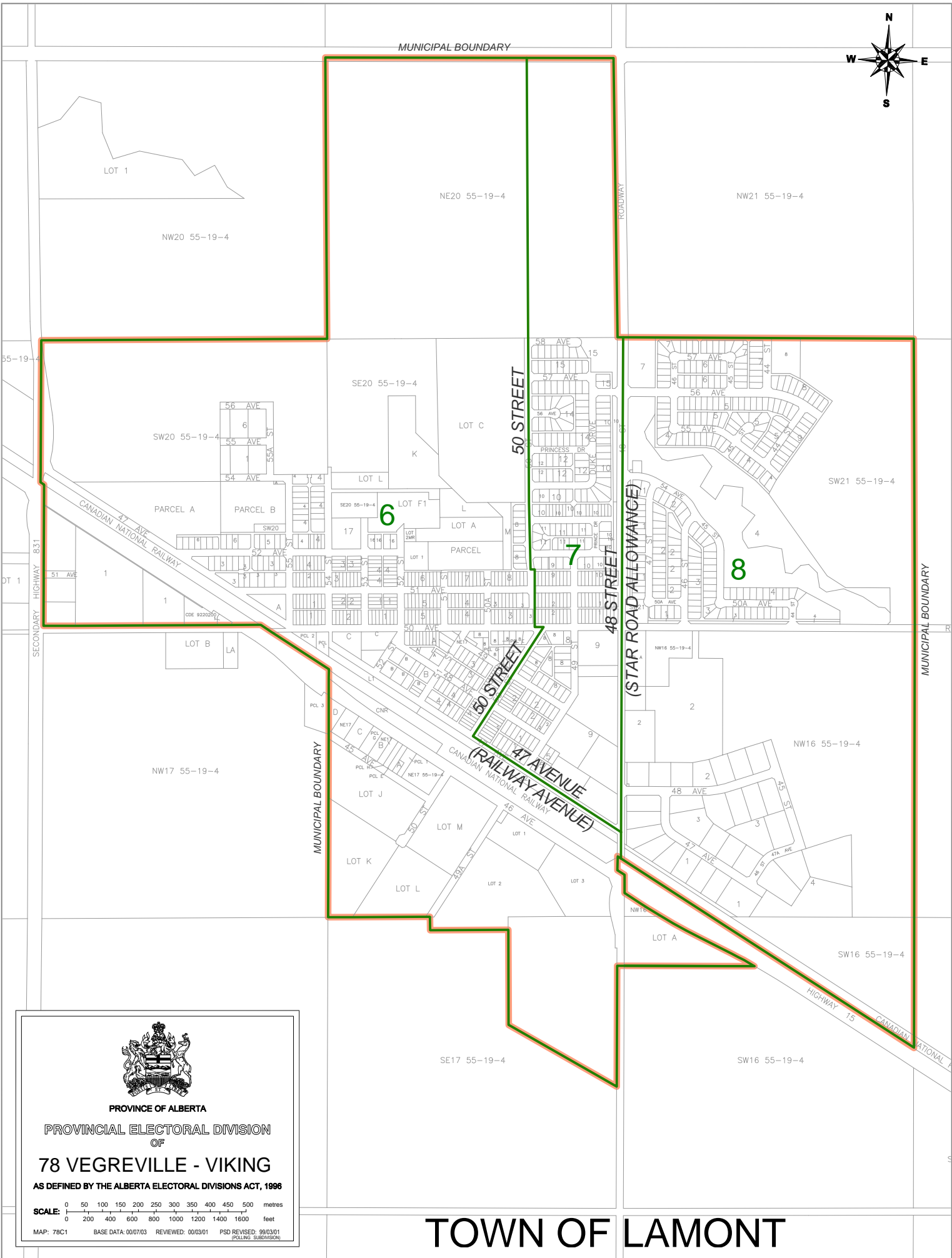

PROVINCE OF ALBERTA

PROVINCIAL ELECTORAL DIVISION
OF

78 VEGREVILLE - VIKING

AS DEFINED BY THE ALBERTA ELECTORAL DIVISIONS ACT, 1996

SCALE: 0 50 100 150 200 250 300 350 400 450 500 metres
0 200 400 600 800 1000 1200 1400 1600 feet

MAP: 78C1 BASE DATA: 00/07/03 REVIEWED: 00/03/01 PSD REVISED: 99/03/01 (POLING SUBDIVISION)

TOWN OF LAMONT

MUNICIPAL BOUNDARY

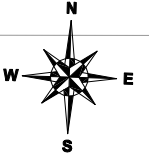

LOT B

SW5 56-20-4

SE5 56-20-4



2

MAINTENANCE YARD A

52 AVENUE

LOT A

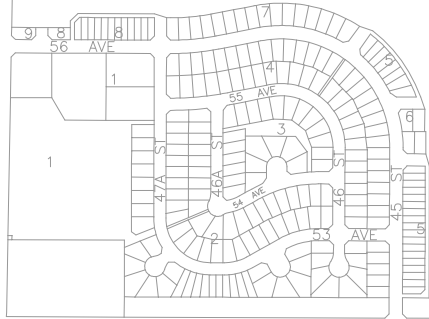

HIGHWAY 45

MUNICIPAL BOUNDARY



48 STREET

LOT 13	NW33 LOT 1
LOT 12	LOT 2
LOT 11	LOT 3
LOT 10PWD	
LOT 9	LOT 4
LOT 8	LOT 5
LOT 7	LOT 6

NW32 55-20-4

3

NE32 55-20-4

PARCEL D

PARCEL C

NW33 55-20-4

CANADIAN NATIONAL RAILWAY

PARCEL B

LOT 1

LOT 2

LOT A

SE32 55-20-4

SW33 55-20-4

CP RAIL

MUNICIPAL BOUNDARY

CANADIAN PACIFIC RAILWAY

SW32 55-20-4

SE32 55-20-4

TOWN OF BRUDERHEIM



PROVINCE OF ALBERTA

PROVINCIAL ELECTORAL DIVISION
OF

78 VEGREVILLE - VIKING

AS DEFINED BY THE ALBERTA ELECTORAL DIVISIONS ACT, 1996

SCALE: 0 50 100 150 200 250 300 350 400 450 metres
0 200 400 600 800 1000 1200 1400 feet

MAP: 78B1 BASE DATA: 00/07/03 REVIEWED: 00/03/01 PSD REVISED: 99/03/01 (POLLING SUBDIVISION)

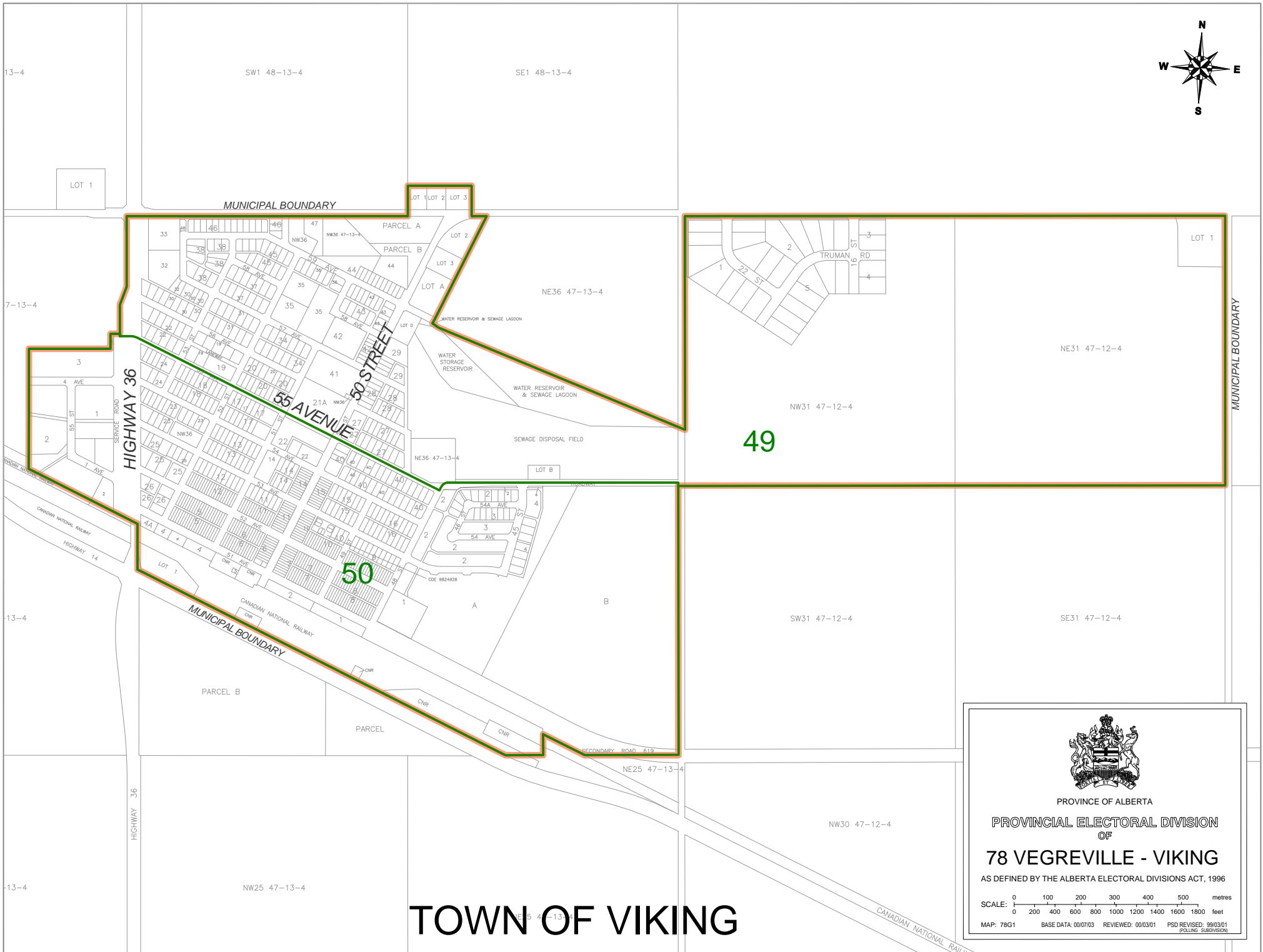
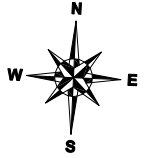

TOWN OF VIKING



PROVINCE OF ALBERTA

PROVINCIAL ELECTORAL DIVISION
OF

78 VEGREVILLE - VIKING

AS DEFINED BY THE ALBERTA ELECTORAL DIVISIONS ACT, 1996

SCALE: 0 200 400 600 800 1000 1200 1400 1600 1800 metres
0 200 400 600 800 1000 1200 1400 1600 1800 feet

MAP: 78G1 BASE DATA: 00/07/03 REVIEWED: 00/03/01 PSD REVISED: 99/03/01
(POLLING SUBDIVISION)

**Electoral Division of Vermilion-Lloydminster
Statement of Official Results - March 12, 2001**

POLL NUMBER	NAME OF POLL	NAMES ON LIST	LLOYD SNELGROVE PC	RAYMOND STONE NDP	DAVID TSCHORN LIB	GRANT WEST AFP	V	S	D	R	% VOTER TURNOUT
1	Ranfurlly	211	74	28	21	2	125	0	0	0	59.2
2	Innisfree	450	149	79	54	13	295	0	0	0	65.6
3	Minburn	343	128	22	11	15	176	0	0	0	51.3
4	Mannville Rural	389	153	32	24	17	226	0	0	0	58.1
5	Mannville	515	172	50	36	14	272	0	0	1	53.0
6	Myrnam Rural	306	91	41	45	12	189	1	0	0	61.8
7	Myrnam	242	60	26	41	11	138	0	0	1	57.4
8	Derwent	335	89	30	35	32	186	0	0	1	55.8
9	Vermilion North West	257	120	13	13	14	160	1	0	0	62.3
10	Vermilion South West	316	133	17	12	8	170	0	0	0	53.8
11	Vermilion South East	288	151	16	12	18	197	0	0	0	68.4
12	Vermilion North East	314	121	15	11	9	156	0	0	1	50.0
13	Clandonald	281	82	21	26	15	144	0	0	0	51.2
14	Landon	196	78	16	12	4	110	0	0	1	56.6
15	Dewberry	371	89	18	12	24	143	0	0	1	38.8
16	Islay	316	113	22	13	18	166	0	0	0	52.5
17	Kitscoty	398	154	27	23	11	215	1	0	0	54.0
18	Kitscoty Rural	323	142	17	4	12	175	0	0	0	54.2
19	Paradise Valley	372	149	10	12	21	192	0	0	0	51.6
20	McLaughlin	242	98	4	3	2	107	0	0	0	44.2
21	Lloydminster South East	307	113	3	5	13	134	0	0	0	43.6
22	Blackfoot	361	129	10	11	9	159	0	0	0	44.0
23	Marwayne Rural	270	104	5	13	11	133	0	0	0	49.3
24	Marwayne	331	149	8	13	10	180	1	0	1	54.7
25	North Saskatchewan River South	248	79	4	4	13	100	0	0	0	40.3
26	Tulliby Lake	228	54	4	7	19	84	0	0	0	36.8
27	Streamstown	392	143	15	14	23	195	1	0	0	49.7
28/37	Lloydminster Blackfoot	564	166	10	11	13	200	0	0	0	35.5
29	Vermilion Airport	371	126	28	36	13	203	0	0	1	55.0
30	Vermilion Stewart Crescent	415	165	28	16	8	217	5	0	0	52.3
31	Vermilion East	375	125	27	32	13	197	0	0	0	52.5
32/36	Vermilion South	310	79	14	18	5	116	0	0	1	37.7
33	Vermilion Center East	395	144	17	15	7	183	1	0	1	46.6
34	Vermilion Center West	361	142	20	28	9	199	0	0	0	55.1
35	Vermilion West	408	167	33	38	13	251	0	0	1	61.8
38	Lloydminster North	389	51	6	7	3	67	0	0	0	17.2
39	Lloydminster Pioneer Lodge	322	89	16	7	5	117	0	0	2	37.0
40	Lloydminster Highway North West	231	60	5	7	1	73	0	0	1	32.0
41	Lloydminster Highway Center	398	96	4	10	4	114	0	0	0	28.6
42	Lloydminster Highway North East	334	84	12	10	7	113	0	0	0	33.8
43	Lloydminster Meridian North	416	125	23	16	9	173	0	0	0	41.6
44	Lloydminster Meridian South	342	123	7	18	1	149	0	0	1	43.9
45	Lloydminster 36 Street North	403	122	9	11	13	155	0	0	0	38.5
46	Lloydminster Highway South	463	98	13	17	6	134	1	0	1	29.2
47	Lloydminster 57 Avenue West	367	123	10	13	2	148	0	0	1	40.6
48	Lloydminster 59 Avenue East	323	97	6	8	2	113	1	0	1	35.3
49	Lloydminster Ring Road	269	90	12	6	4	112	0	0	0	41.6
50	Lloydminster Parkland	359	107	7	20	3	137	0	0	0	38.2
51	Lloydminster Messum Lake	455	99	5	16	3	123	0	0	0	27.0
52	Lloydminster 36 Street South	447	132	12	13	6	163	0	0	0	36.5
53	Lloydminster Apartments	432	30	4	9	3	46	0	0	0	10.6
54	Lloydminster Cedar Block	271	61	4	13	7	85	0	0	0	31.4
55	Lloydminster 27 Street North	375	130	11	9	7	157	0	0	0	41.9
56	Lloydminster South	416	151	10	13	8	182	0	0	0	43.8

**Electoral Division of Vermilion-Lloydminster
Statement of Official Results - March 12, 2001**

POLL NUMBER	NAME OF POLL	NAMES ON LIST	LLOYD SNELGROVE PC	RAYMOND STONE NDP	DAVID TSCHORN LIB	GRANT WEST AFP	V	S	D	R	% VOTER TURNOUT
57	Lloydminster Parkview	515	174	1	6	3	184	0	0	1	35.9
58	Lloydminster College	519	181	4	16	2	203	0	0	1	39.3
59	Advance - Innisfree	0	17	5	3	0	25	0	0	0	
60	Advance - Vermilion	0	171	21	23	16	231	0	0	1	
61	Advance - Lloydminster	0	244	23	17	15	299	0	0	0	
62	Mobile - Mannville/Myrnam/ Vermilion	0	41	11	8	6	66	0	0	4	
63	Mobile - Lloydminster	0	14	3	1	2	20	0	0	0	
64	Special Ballot	0	37	2	2	0	41	0	0	9	
TOTAL		19,847	6,978	976	980	589	9,523	13	0	34	48.2

V = Valid Ballots S = Spoiled Ballots D = Declined Ballots R = Rejected Ballots



13 12 11 10 9 8 7 6 5 4 3 2 1 57

Vegreville - Viking

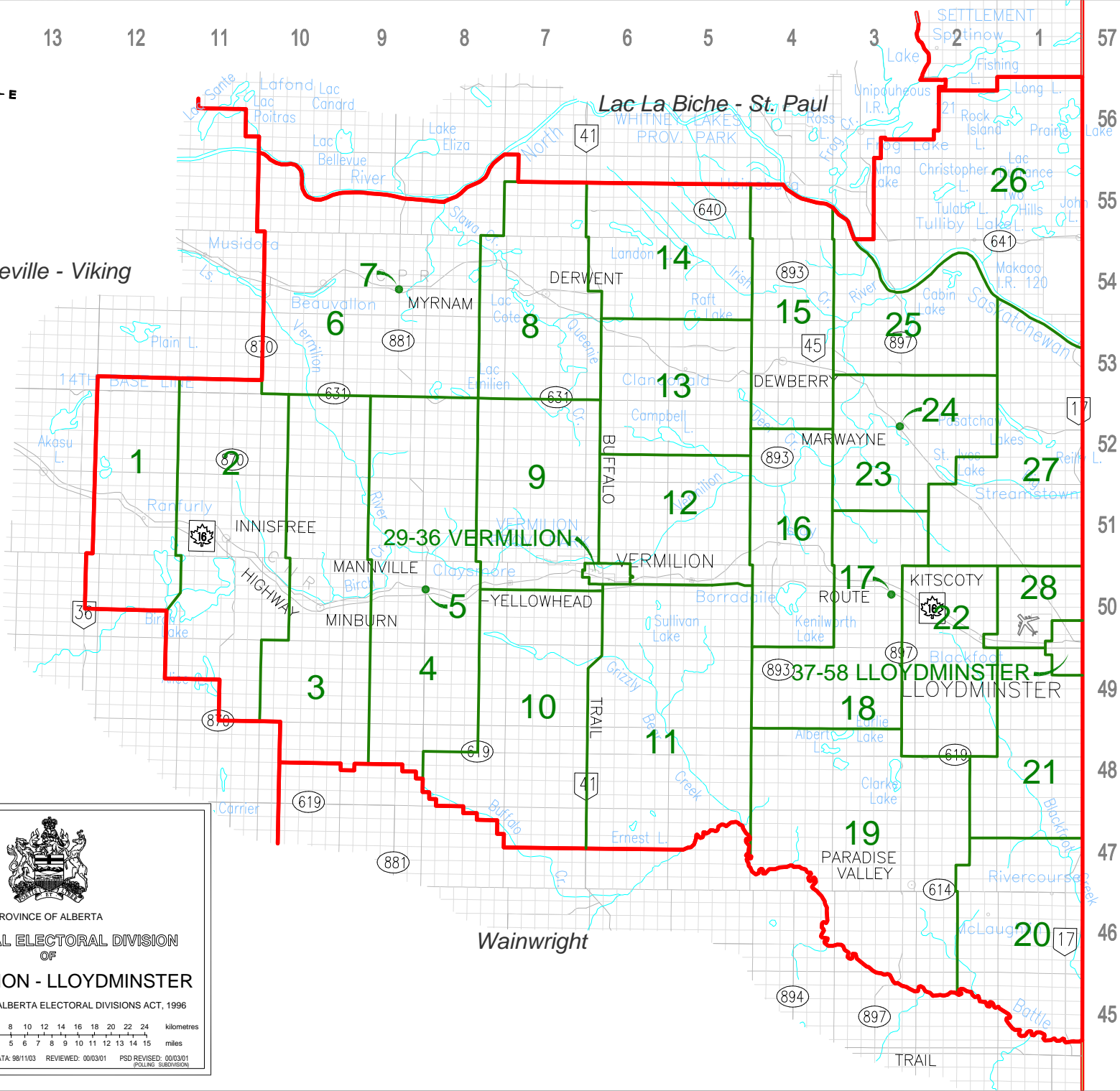

Wainwright



PROVINCE OF ALBERTA

PROVINCIAL ELECTORAL DIVISION
OF

79 VERMILION - LLOYDMINSTER

AS DEFINED BY THE ALBERTA ELECTORAL DIVISIONS ACT, 1996

SCALE: 0 2 4 6 8 10 12 14 16 18 20 22 24 kilometres
0 1 2 3 4 5 6 7 8 9 10 11 12 13 14 15 miles

MAP: 79A1 BASE DATA: 99/1103 REVIEWED: 00/03/01 PSD REVISED: 00/03/01
POLLING SUBDIVISION

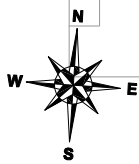

MUNICIPAL BOUNDARY

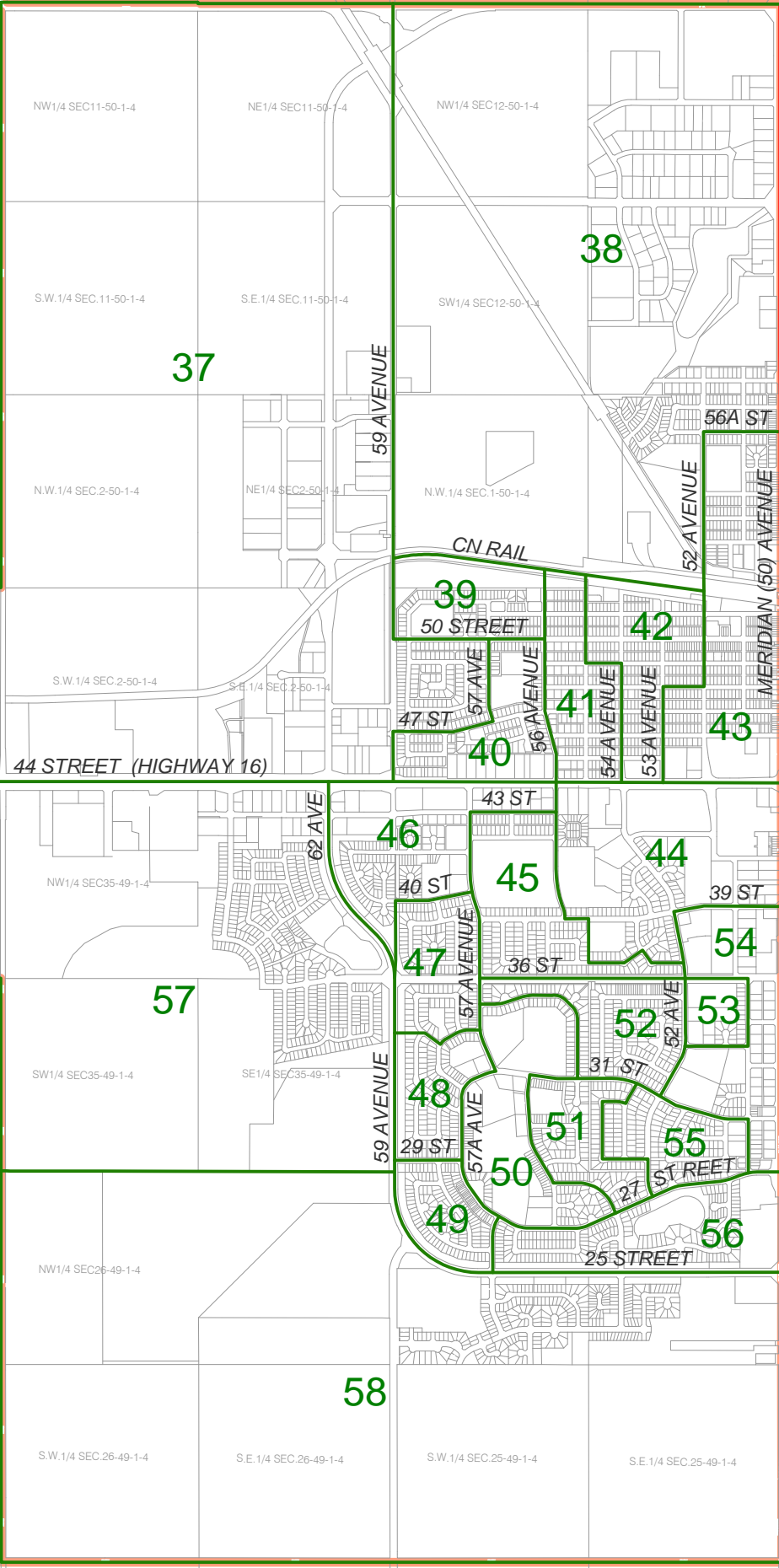

PROVINCE OF ALBERTA

PROVINCIAL ELECTORAL DIVISION
OF

79 VERMILION - LLOYDMINSTER

AS DEFINED BY THE ALBERTA ELECTORAL DIVISIONS ACT, 1996

SCALE: 0 100 200 300 400 500 600 700 800 900 1000 metres
0 500 1000 1500 2000 2500 3000 3500 feet

MAP: 79B1 BASE DATA: 00/07/03 REVIEWED: 00/03/01 PSD REVISED: 00/03/01 (POLING SUBMISSION)

MUNICIPAL BOUNDARY

CITY OF LLOYDMINSTER

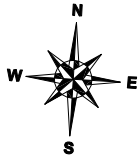

MUNICIPAL BOUNDARY

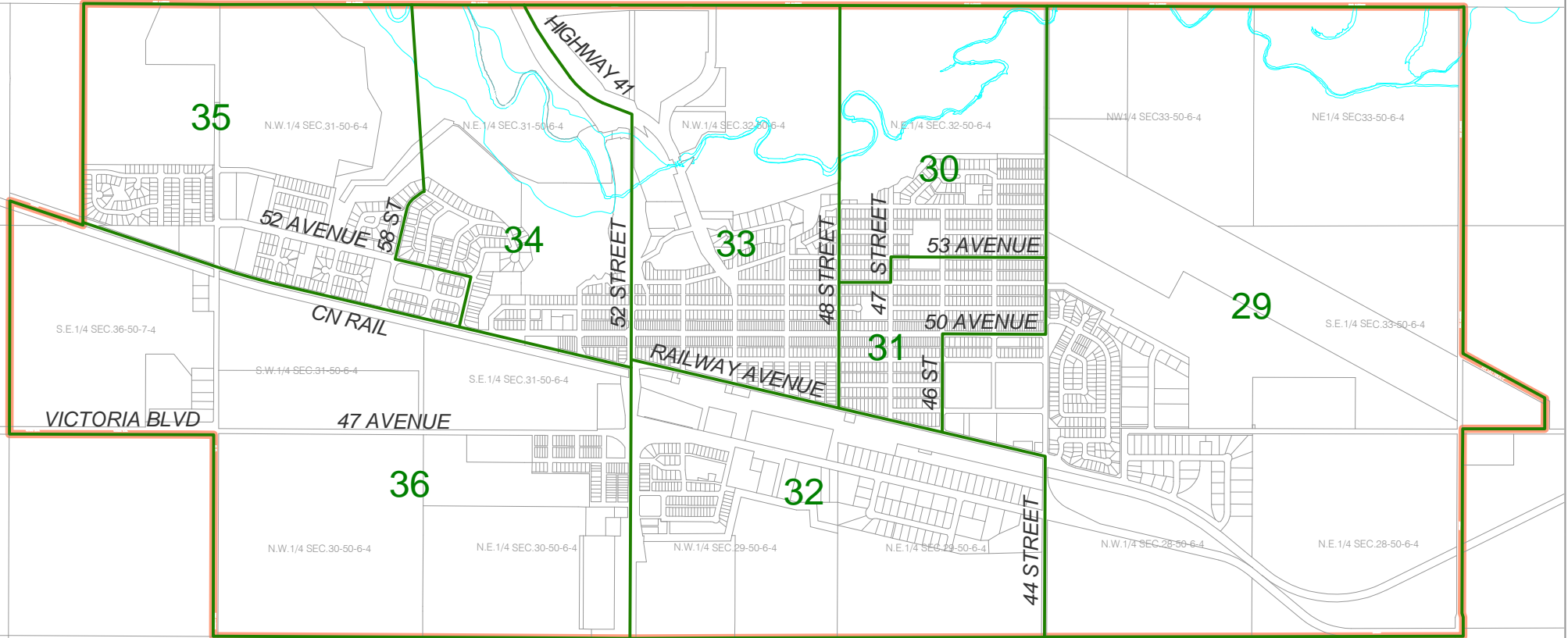

MUNICIPAL BOUNDARY

TOWN OF VERMILION



PROVINCE OF ALBERTA

PROVINCIAL ELECTORAL DIVISION
OF

79 VERMILION - LLOYDMINSTER

AS DEFINED BY THE ALBERTA ELECTORAL DIVISIONS ACT, 1996

SCALE: 0 100 200 300 400 500 600 700 800 900 metres
0 1000 1500 2000 2500 3000 feet

MAP: 79C1 BASE DATA: 00/07/03 REVIEWED: 00/03/01 PSD REVISED: 99/03/01
POLLING SUBDIVISION